

TYPICAL SECTION LABELS

IDENTIFIER	MATERIAL
(A)	401005: 1-1/4" BITUMINOUS CONCRETE, TYPE "C", PG 64-22, CARBONATE STONE
(B)	401005: 1-1/2" BITUMINOUS CONCRETE, TYPE "C", PG 64-22
(C)	401014: 2-1/4" BITUMINOUS CONCRETE, TYPE "B", PG 64-22
(D)	301001: 8" GRADED AGGREGATE BASE COURSE, TYPE B
(E)	760006: 2" MILL AND OVERLAY SUPERPAVE TYPE "C" NON-CARBONATE STONE, PG 70-22, (401045)
(F)	PROVIDE 6" TOPSOIL (908010), PERMANENT GRASS SEEDING-DRY GROUND (P8-DG) (908014) AND MULCHING STRAW (908020) PER DELDOT SPECIFICATIONS.
(G)	DELDOT P.C.C. CURB TYPE 1-6 (701022) ON MIN. 6" G.A.B.C. (301003).
(H)	4" CONCRETE SIDEWALK (705001) ON MIN. 6" G.A.B.C. (301003).

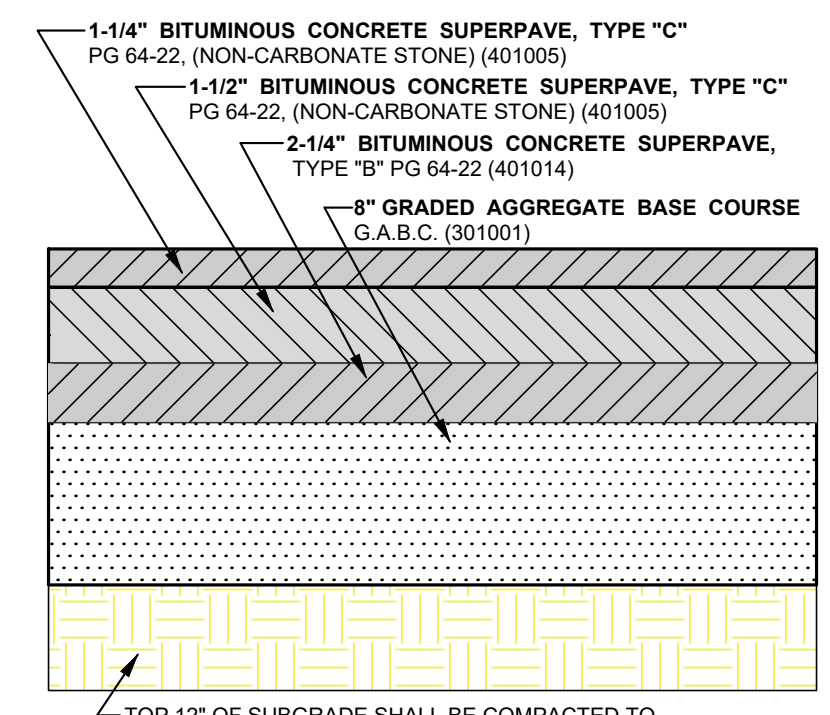

TOP 12" OF SUBGRADE SHALL BE COMPACTED TO 95% OF THE MODIFIED PROCTOR STANDARD DRY DENSITY AS DETERMINED BY THE MODIFIED PROCTOR TEST, ASTM D 1557

**PAVEMENT SECTION SN: 3.40
HOWELL ST. / ASBURY AVE.
PAVEMENT SECTION DETAIL**

NO SCALE BMG NO.: SW-2A

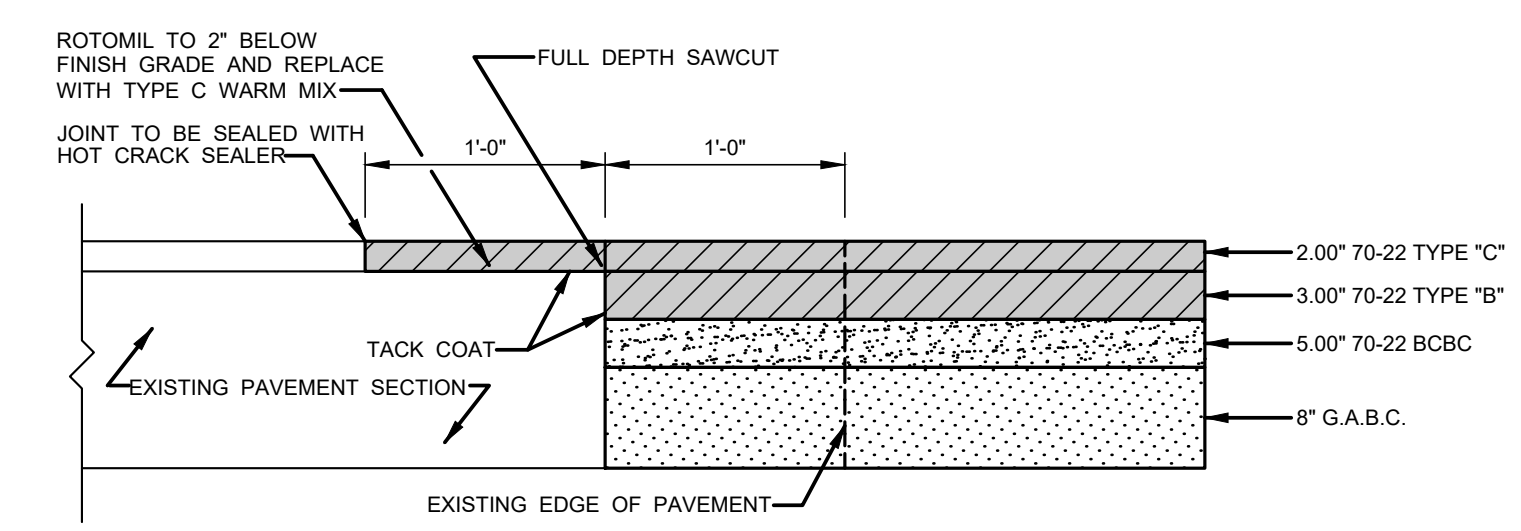

PAVEMENT TIE-IN SECTION

NO SCALE BMG NO.: SW-2D

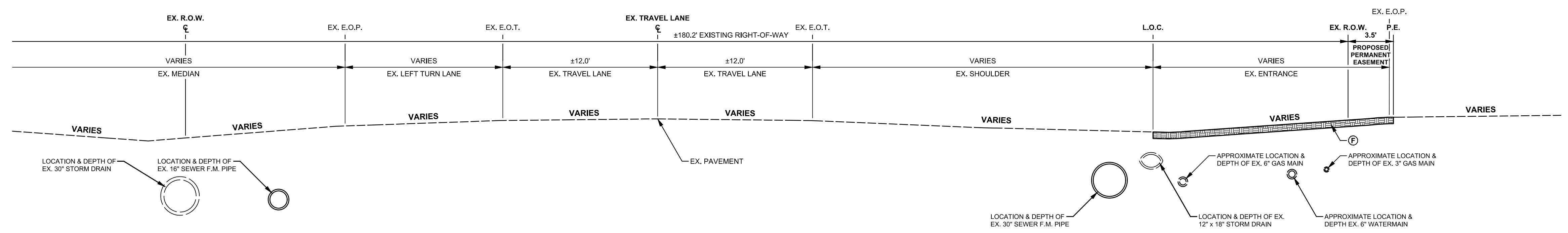

SOUTH DUPONT HIGHWAY (U.S. ROUTE 13) TYPICAL ROADWAY SECTION A-A (STAT: 1+00 - 1+50)

SCALE: 1" = 5'

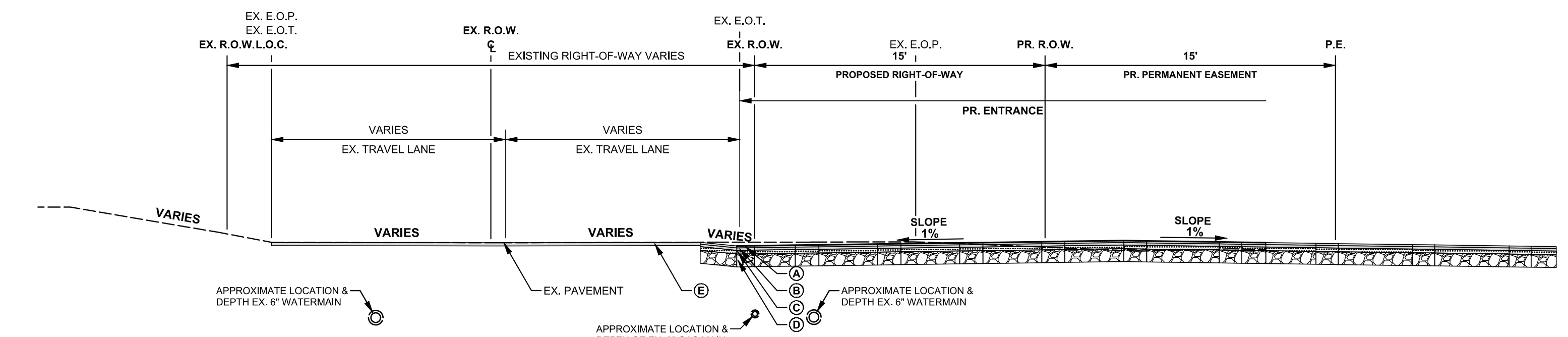

HOWELL STREET TYPICAL ROADWAY SECTION B-B (STAT: 0+50)

SCALE: 1" = 5'

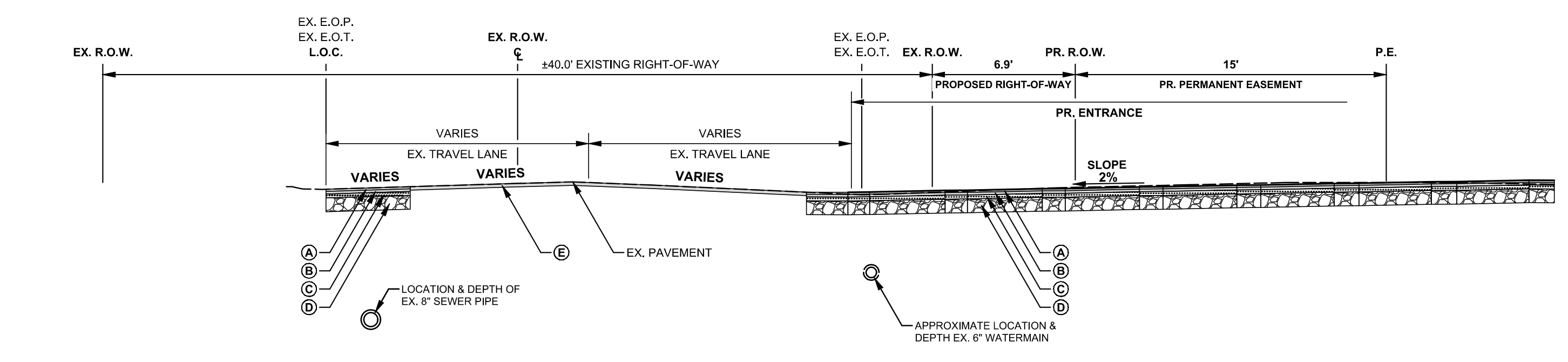

ASBURY AVENUE TYPICAL ROADWAY SECTION C-C (STAT: 0+50)

SCALE: 1" = 5'

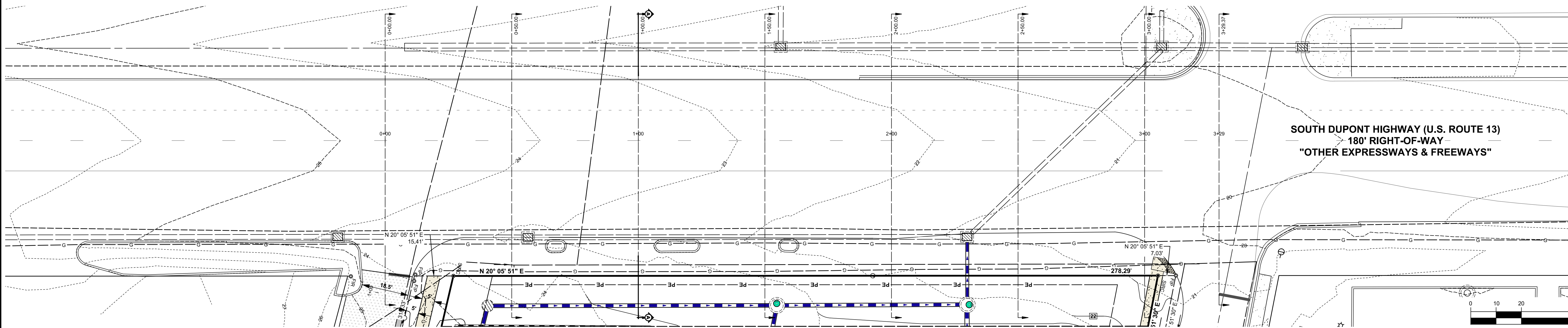

SOUTH DUPONT HIGHWAY CROSS SECTION PLAN

SCALE: 1" = 20'



PROJECT TITLE

DOLLAR GENERAL CAMDEN

2035 SOUTH DUPONT HIGHWAY
TOWN OF CAMDEN
KENT COUNTY, DELAWARE

SHEET TITLE

**ENTRANCE PLANS:
TYPICAL CROSS
SECTIONS - SOUTH
DuPONT HIGHWAY**

ISSUE BLOCK

NO.	DATE	DESCRIPTION
3.	5/4/20	REVISED PER KCD COMMENTS DATED 4/15/20
2.	4/30/20	REVISED PER DELDOT COMMENTS DATED 4/3/20
1.	3/6/20	REVISED PER KENT COUNTY PUBLIC WORK COMMENTS DATED 3/4/20

PROJECT NO.: 2019207.00
DATE: 1/27/20
SCALE: AS SHOWN
DRAWN BY: J.D.K. / PROJ. MGR.: J.N.S.

C-606

COPYRIGHT 2019

TYPICAL SECTION LABELS

IDENTIFIER	MATERIAL
(A)	401005: 1-1/4" BITUMINOUS CONCRETE, TYPE "C", PG 64-22, CARBONATE STONE
(B)	401005: 1-1/2" BITUMINOUS CONCRETE, TYPE "C", PG 64-22
(C)	401014: 2-1/4" BITUMINOUS CONCRETE, TYPE "B", PG 64-22
(D)	301001: 8" GRADED AGGREGATE BASE COURSE, TYPE B
(E)	760006: 2" MILL AND OVERLAY SUPERPAVE TYPE "C" NON-CARBONATE STONE, PG 70-22, 401045
(F)	PROVIDE 6" TOPSOIL (908010), PERMANENT GRASS SEEDING-DRY GROUND (P8-DG) (908014) AND MULCHING STRAW (908020) PER DELDOT SPECIFICATIONS.
(G)	DELDOT P.C.C. CURB TYPE 1-6 (701022) ON MIN. 6" GABC (301003).
(H)	4" CONCRETE SIDEWALK (705001) ON MIN. 6" GABC (301003).



ARCHITECTURE
ENGINEERING

Dover, DE
309 S. Governors Ave.
Dover, DE 19904
Ph. 302.734.7950
Fax 302.734.7965

Salisbury, MD
312 West Main St. Suite 300
Salisbury, MD 21801
Ph. 410.546.9100
Fax 410.546.5824

Wilmington, NC
3333 Jaeckle Drive, Suite 120
Wilmington, North Carolina 28403
Ph. 910.341.7600
Fax 910.341.7506

www.beckermorgan.com

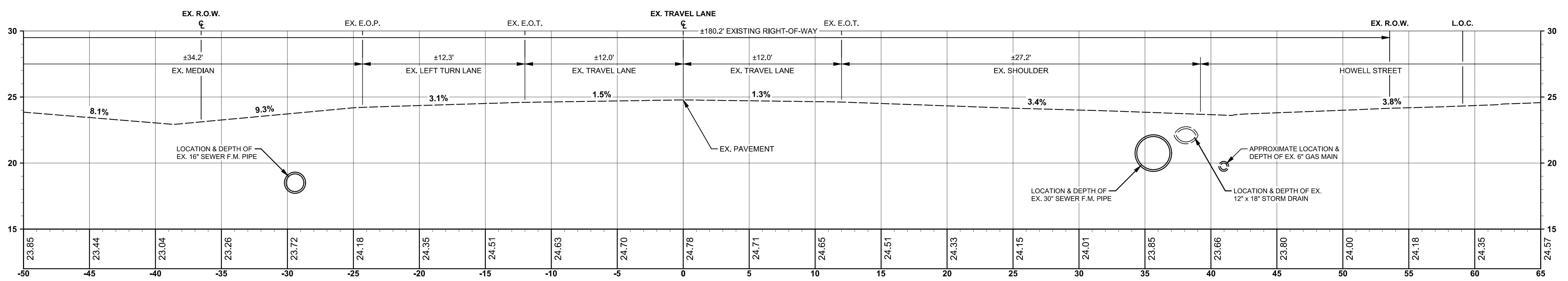

SOUTH DuPONT HIGHWAY (U.S. ROUTE 113) - 0+00.00

SCALE: 1" = 5'

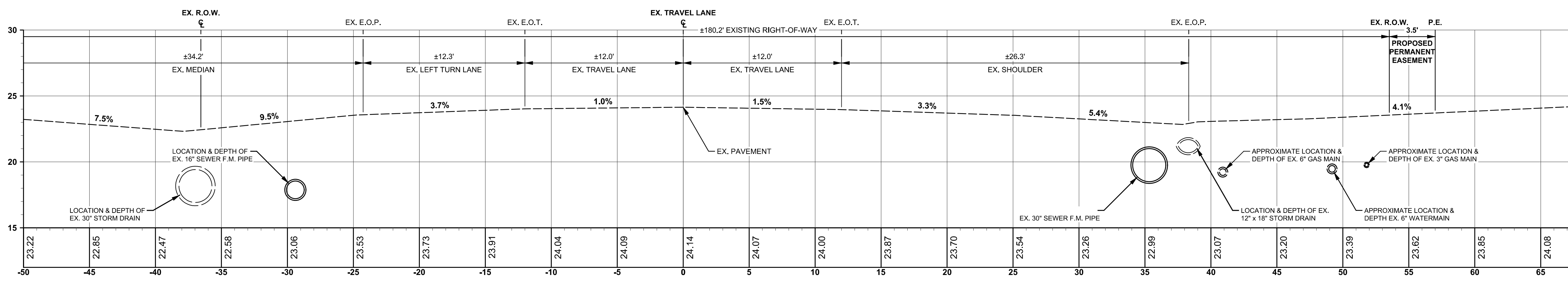

SOUTH DuPONT HIGHWAY (U.S. ROUTE 113) - 0+50.00

SCALE: 1" = 5'

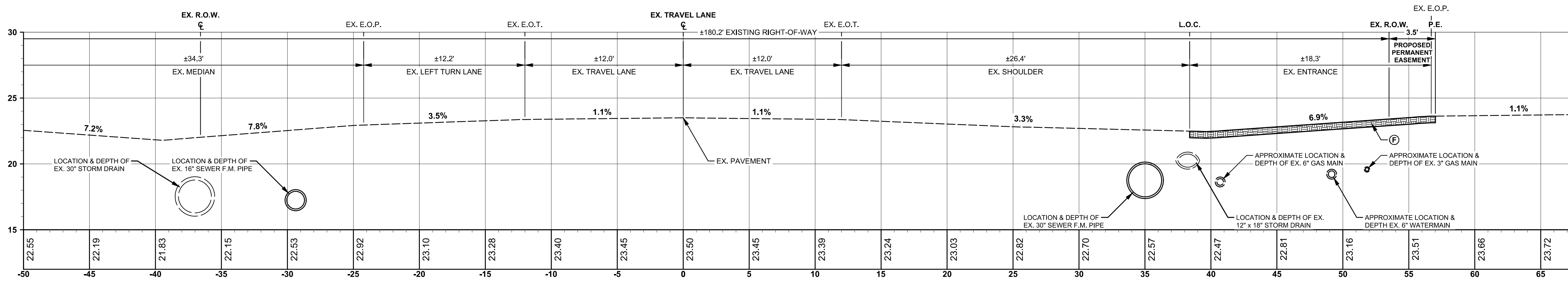

SOUTH DuPONT HIGHWAY (U.S. ROUTE 113) - 1+00.00

SCALE: 1" = 5'

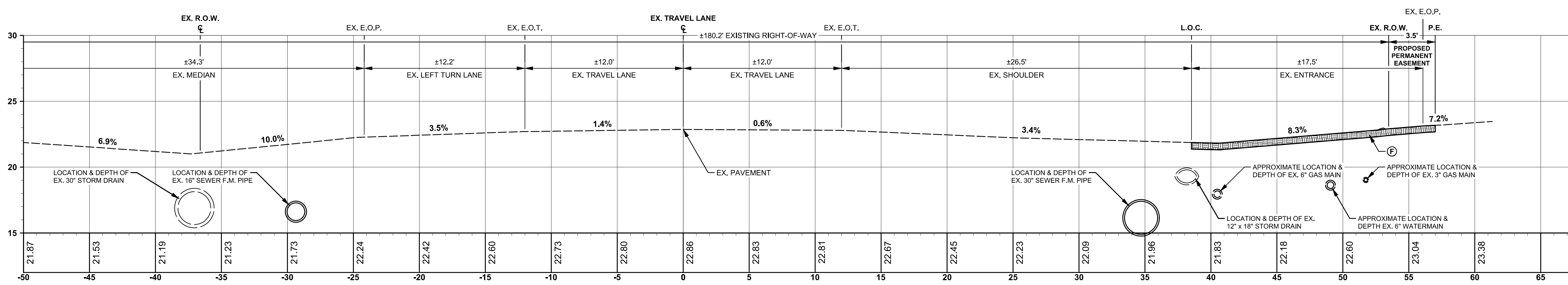

SOUTH DuPONT HIGHWAY (U.S. ROUTE 113) - 1+50.00

SCALE: 1" = 5'

PROJECT TITLE

**DOLLAR
GENERAL
CAMDEN**

2035 SOUTH DUPONT HIGHWAY
TOWN OF CAMDEN
KENT COUNTY, DELAWARE

SHEET TITLE

**ENTRANCE PLANS:
CROSS SECTIONS
SOUTH DuPONT
HIGHWAY**

ISSUE BLOCK

NO.	DATE	DESCRIPTION
3.	5/4/20	REVISED PER KCD COMMENTS DATED 4/15/20
2.	4/30/20	REVISED PER DELDOT COMMENTS DATED 4/30/20
1.	3/6/20	REVISED PER KENT COUNTY PUBLIC WORK COMMENTS DATED 3/4/20

MARK DATE DESCRIPTION

LAYER/STATE: C-607

PROJECT NO.: 2019207.00

DATE: 1/27/20

SCALE: 1" = 5'

DRAWN BY: J.D.K. PROJ. MGR.: J.N.S.

SHEET

C-607

COPYRIGHT: 2019

TYPICAL SECTION LABELS

IDENTIFIER	MATERIAL
(A)	401005: 1-1/4" BITUMINOUS CONCRETE, TYPE "C", PG 64-22, CARBONATE STONE
(B)	401005: 1-1/2" BITUMINOUS CONCRETE, TYPE "C", PG 64-22
(C)	401014: 2-1/4" BITUMINOUS CONCRETE, TYPE "B", PG 64-22
(D)	301001: 8" GRADED AGGREGATE BASE COURSE, TYPE B
(E)	760006: 2" MILL AND OVERLAY SUPERPAVE TYPE "C" NON-CARBONATE STONE, PG 70-22, 401045
(F)	PROVIDE 6" TOPSOIL (908010), PERMANENT GRASS SEEDING-DRY GROUND (P8-DG) (908014) AND MULCHING STRAW (908020) PER DELDOT SPECIFICATIONS.
(G)	DELDOT P.C.C. CURB TYPE 1-6 (701022) ON MIN. 6" GABC (301003).
(H)	4" CONCRETE SIDEWALK (705001) ON MIN. 6" GABC (301003).



ARCHITECTURE
ENGINEERING

Dover, DE
309 S. Governors Ave.
Dover, DE 19904
Ph. 302.734.7950
Fax 302.734.7965

Salisbury, MD
312 West Main St. Suite 300
Salisbury, MD 21801
Ph. 410.546.9100
Fax 410.546.5824

Wilmington, NC
3333 Jaccle Drive, Suite 120
Wilmington, North Carolina 28403
Ph. 910.341.7600
Fax 910.341.7506

www.beckermorgan.com

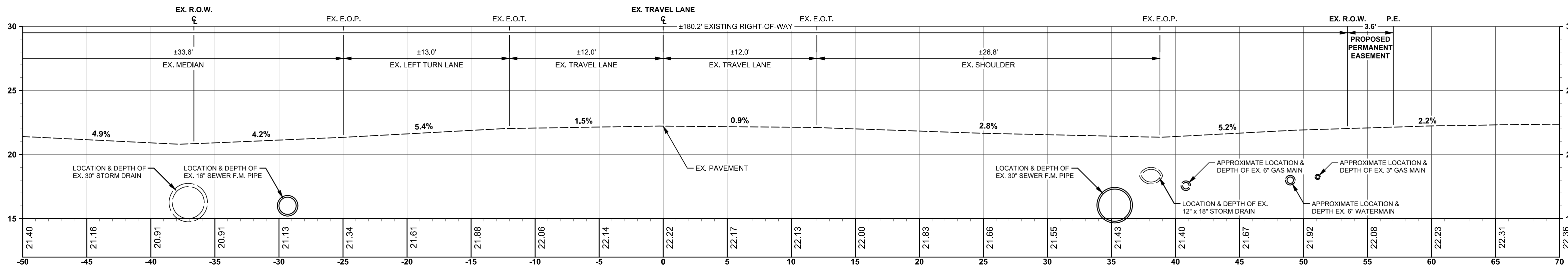

SOUTH DuPONT HIGHWAY (U.S. ROUTE 113) - 2+00.00

SCALE: 1" = 5'

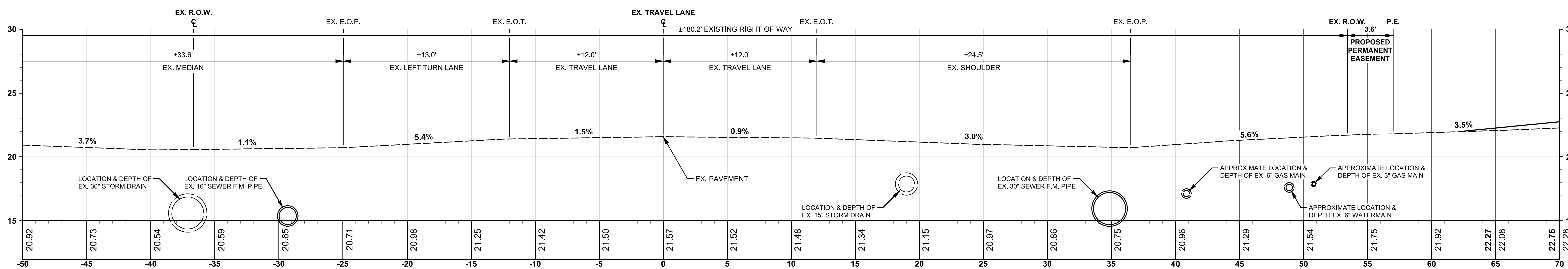

SOUTH DuPONT HIGHWAY (U.S. ROUTE 113) - 2+50.00

SCALE: 1" = 5'

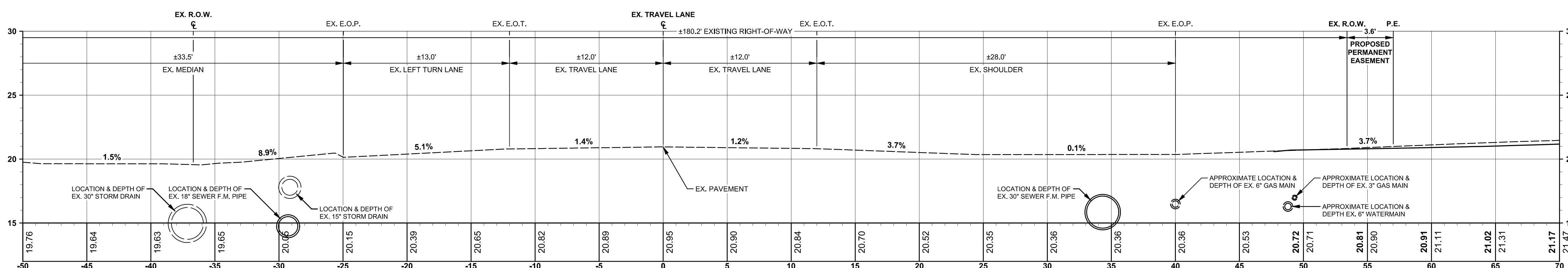

SOUTH DuPONT HIGHWAY (U.S. ROUTE 113) - 3+00.00

SCALE: 1" = 5'

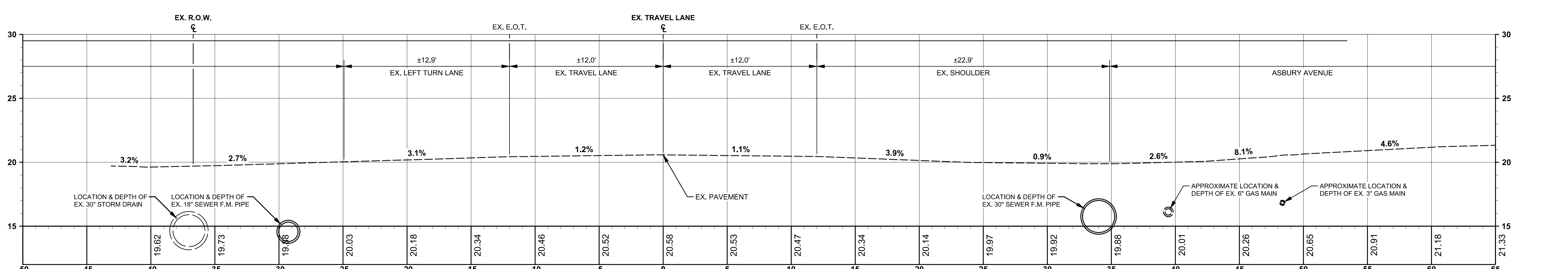

SOUTH DuPONT HIGHWAY (U.S. ROUTE 113) - 3+29.37

SCALE: 1" = 5'

PROJECT TITLE

**DOLLAR
GENERAL
CAMDEN**

2035 SOUTH DUPONT HIGHWAY
TOWN OF CAMDEN
KENT COUNTY, DELAWARE

SHEET TITLE

**ENTRANCE PLANS:
CROSS SECTIONS
SOUTH DuPONT
HIGHWAY**

ISSUE BLOCK

NO.	DATE	DESCRIPTION
3.	5/4/20	REVISED PER KCD COMMENTS DATED 4/15/20
2.	4/30/20	REVISED PER DELDOT COMMENTS DATED 4/3/20
1.	3/6/20	REVISED PER KENT COUNTY PUBLIC WORK COMMENTS DATED 3/4/20

PROJECT NO.: 2019207.00

DATE: 1/27/20

SCALE: 1" = 5'

DRAWN BY: J.D.K. | PROJ. MGR.: J.N.S.

SHEET

C-608

COPYRIGHT 2019

TYPICAL SECTION LABELS

IDENTIFIER	MATERIAL
(A)	401005: 1-1/4" BITUMINOUS CONCRETE, TYPE "C", PG 64-22, CARBONATE STONE
(B)	401005: 1-1/2" BITUMINOUS CONCRETE, TYPE "C", PG 64-22
(C)	401014: 2-1/4" BITUMINOUS CONCRETE, TYPE "B", PG 64-22
(D)	301001: 8" GRADED AGGREGATE BASE COURSE, TYPE B
(E)	760006: 2" MILL AND OVERLAY SUPERPAVE TYPE "C" NON-CARBONATE STONE, PG 70-22, (401045)
(F)	PROVIDE 6" TOPSOIL (909010), PERMANENT GRASS SEEDING-DRY GROUND (P8-DG) (908014) AND MULCHING STRAW (908020) PER DELDOT SPECIFICATIONS.
(G)	DELDOT P.C.C. CURB TYPE 1-6 (701022) ON MIN. 6" GABC (301003).
(H)	4" CONCRETE SIDEWALK (705001) ON MIN. 6" GABC (301003).

BECKER MORGAN GROUP

ARCHITECTURE
ENGINEERING

Dover, DE
309 S. Governors Ave.
Dover, DE 19904
Ph. 302.734.7950
Fax 302.734.7965

Salisbury, MD
312 West Main St. Suite 300
Salisbury, MD 21801
Ph. 410.546.9100
Fax 410.546.5824

Wilmington, NC
3333 Jaecle Drive, Suite 120
Wilmington, North Carolina 28403
Ph. 910.341.7600
Fax 910.341.7506

www.beckermorgan.com

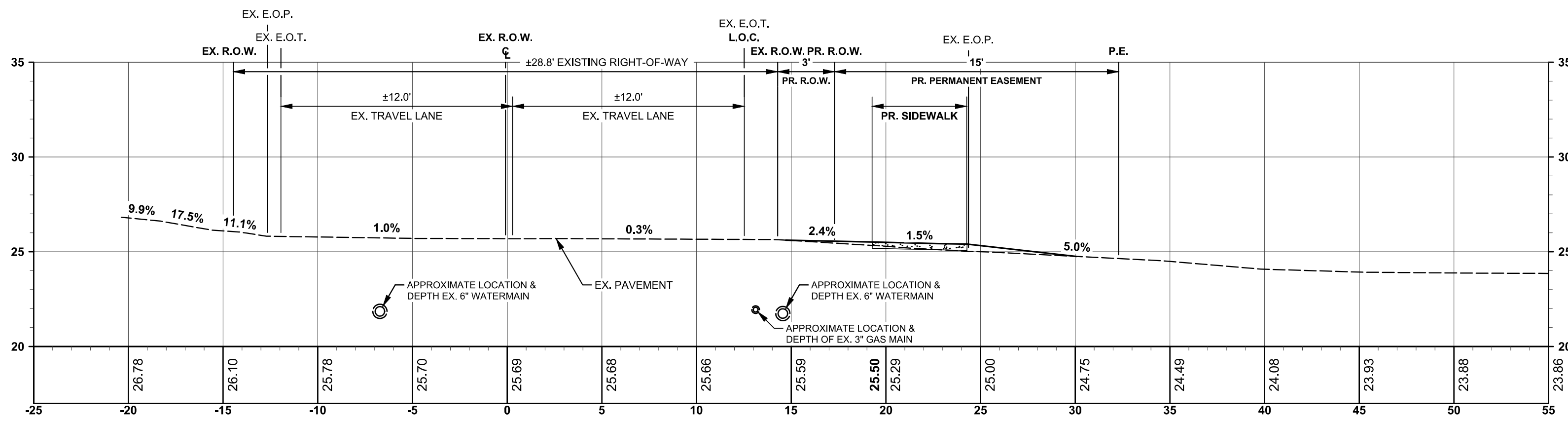
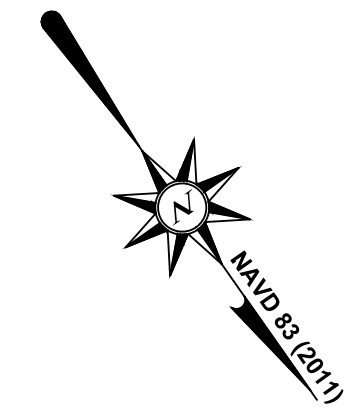

HOWELL STREET - 0+00.00

SCALE: 1" = 5'

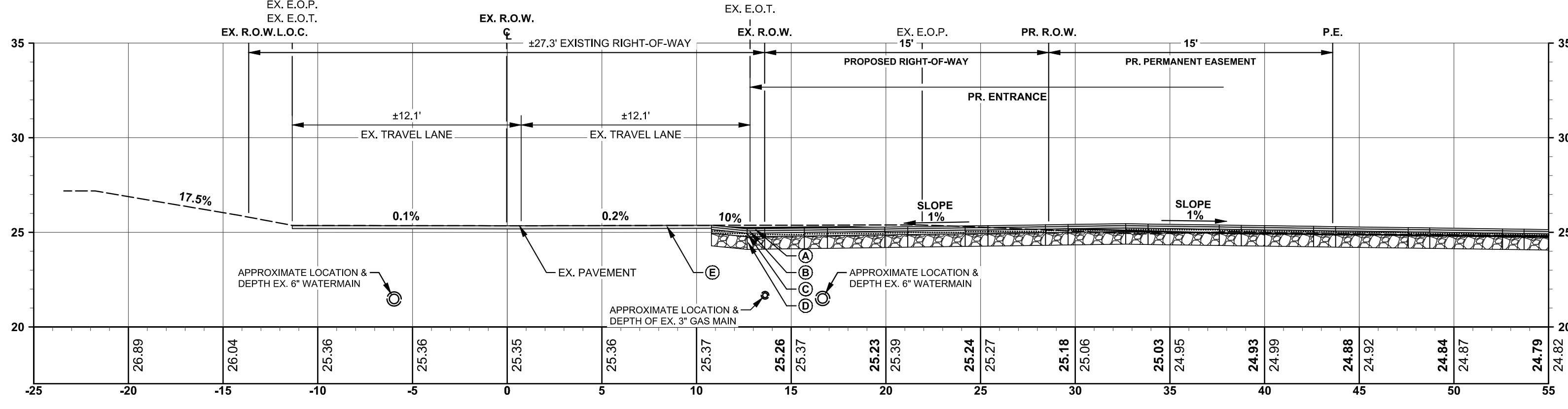

HOWELL STREET - 0+50.00

SCALE: 1" = 5'

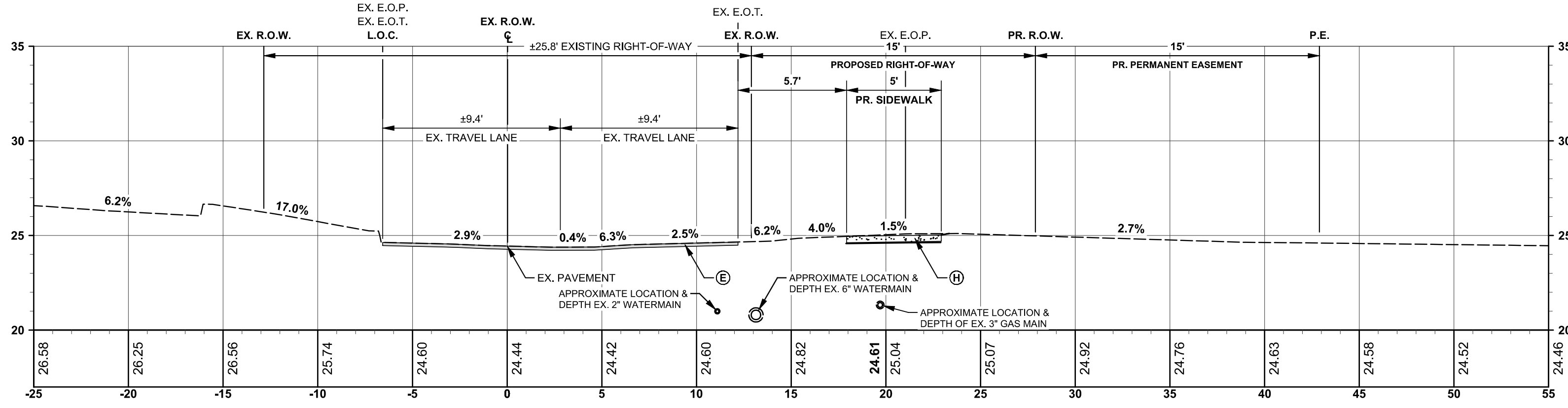

HOWELL STREET - 1+00.00

SCALE: 1" = 5'

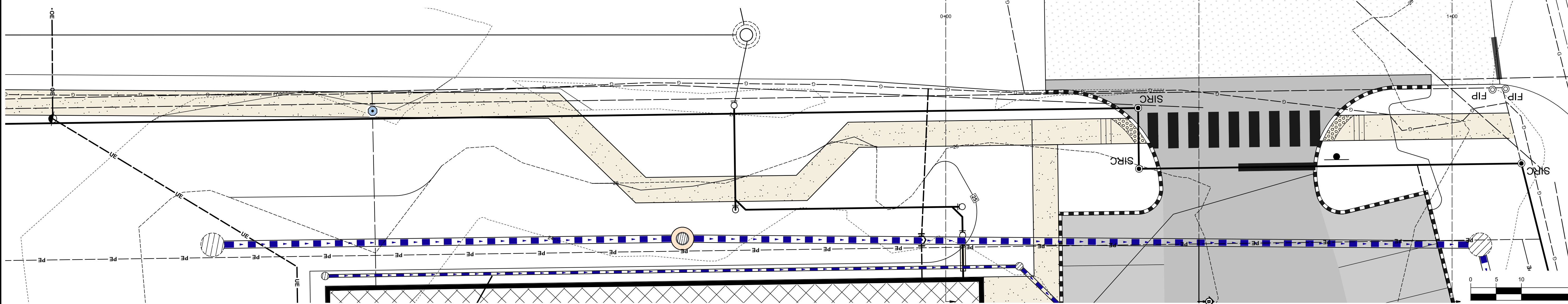

HOWELL STREET ENTRANCE CROSS SECTION PLAN

SCALE: 1" = 10'

PROJECT TITLE

**DOLLAR GENERAL
CAMDEN**

2035 SOUTH DUPONT HIGHWAY
TOWN OF CAMDEN
KENT COUNTY, DELAWARE

SHEET TITLE

**ENTRANCE PLANS:
CROSS SECTIONS
HOWELL STREET**

ISSUE BLOCK

MARK	DATE	DESCRIPTION
3	5/4/20	REVISED PER KCD COMMENTS DATED 4/15/20
2	4/30/20	REVISED PER DELDOT COMMENTS DATED 4/3/20
1	3/6/20	REVISED PER KENT COUNTY PUBLIC WORK COMMENTS DATED 3/4/20

PROJECT NO.: 2019207.00

DATE: 1/27/20

SCALE: AS SHOWN

DRAWN BY: J.D.K. PROJ. MGR.: J.N.S.

SHEET

C-609

COPYRIGHT 2019

F:\AutoCAD\Projects\2019\2019207\DWG\2019207-SITE-C3D18.dwg, Apr 30, 2020 - 5:56pm

TYPICAL SECTION LABELS

IDENTIFIER	MATERIAL
(A)	401005: 1-1/4" BITUMINOUS CONCRETE, TYPE "C"; PG 64-22, CARBONATE STONE
(B)	401005: 1-1/2" BITUMINOUS CONCRETE, TYPE "C"; PG 64-22
(C)	401014: 2-1/4" BITUMINOUS CONCRETE, TYPE "B"; PG 64-22
(D)	301001: 8" GRADED AGGREGATE BASE COURSE, TYPE B
(E)	760006: 2" MILL AND OVERLAY SUPERPAVE TYPE "C" NON-CARBONATE STONE, PG 70-22, 401045
(F)	PROVIDE 6" TOPSOIL (908010), PERMANENT GRASS SEEDING-DRY GROUND (P8-DG) (908014) AND MULCHING STRAW (908030) PER DELDOT SPECIFICATIONS.
(G)	DELDOT P.C.C. CURB TYPE 1-6 (701022) ON MIN. 6" GABC (301003).
(H)	4" CONCRETE SIDEWALK (705001) ON MIN. 6" GABC (301003).



**ARCHITECTURE
ENGINEERING**

Dover, DE
309 S. Governors Ave.
Dover, DE 19904
Ph. 302.734.7950
Fax 302.734.7965

Salisbury, MD
312 West Main St. Suite 300
Salisbury, MD 21801
Ph. 410.546.9100
Fax 410.546.5824

Wilmington, NC
3333 Jaeckle Drive, Suite 120
Wilmington, North Carolina 28403
Ph. 910.341.7600
Fax 910.341.7506

www.beckermorgan.com

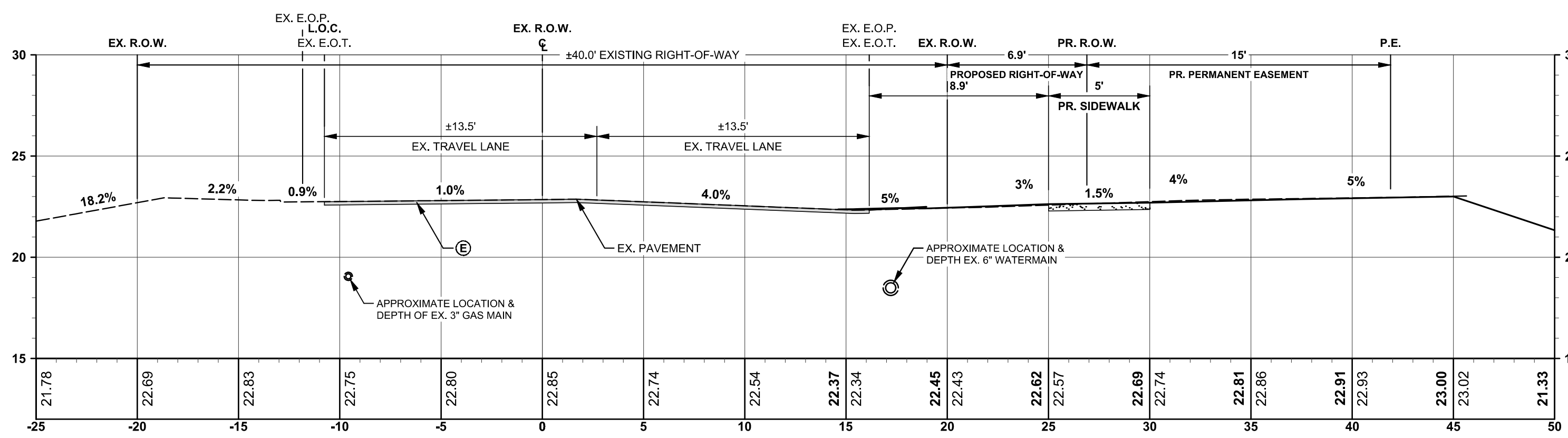
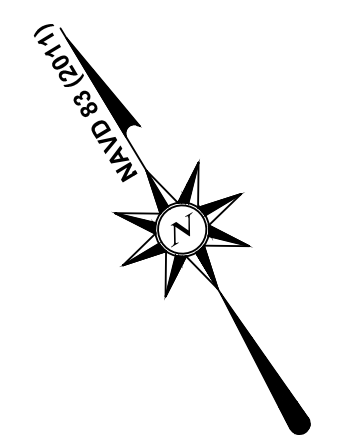

ASBURY AVENUE - 0+00.00

SCALE: 1" = 5'

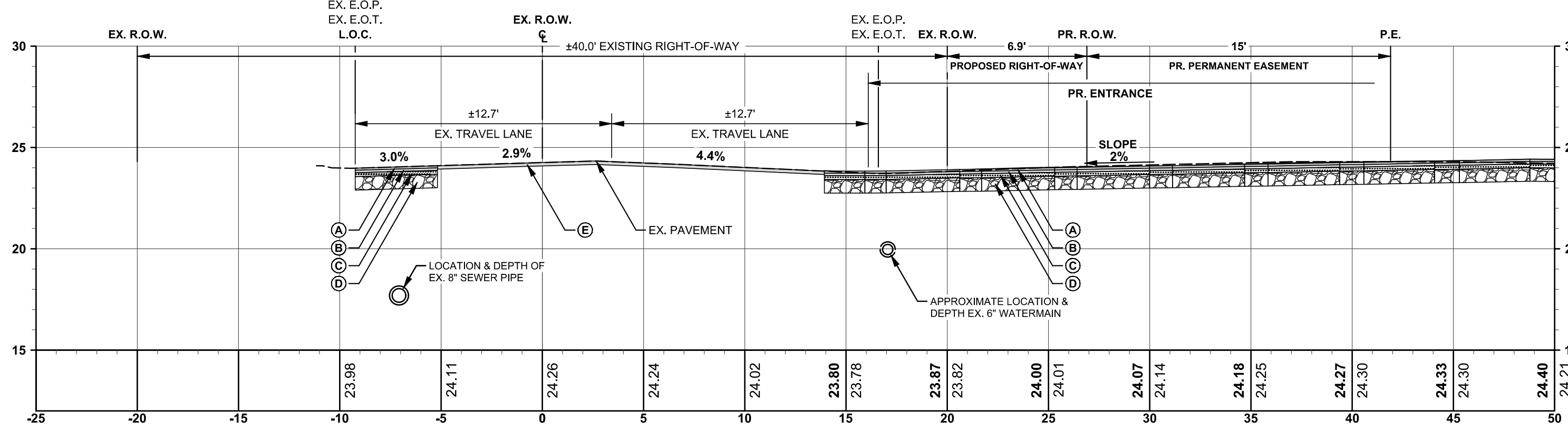

ASBURY AVENUE - 0+50.00

SCALE: 1" = 5'

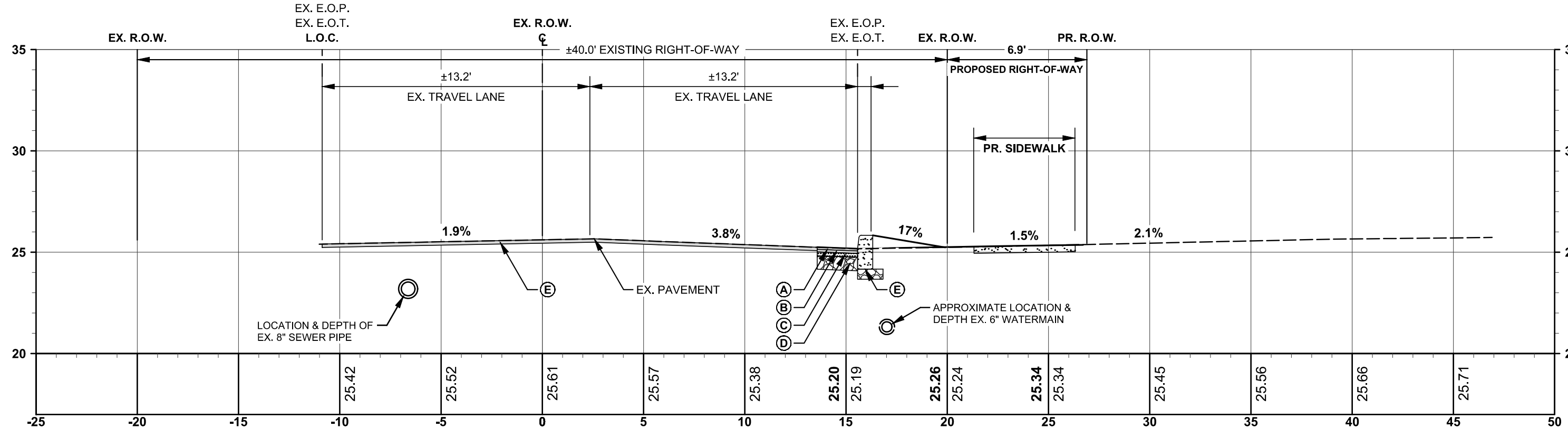

ASBURY AVENUE - 1+00.00

SCALE: 1" = 5'

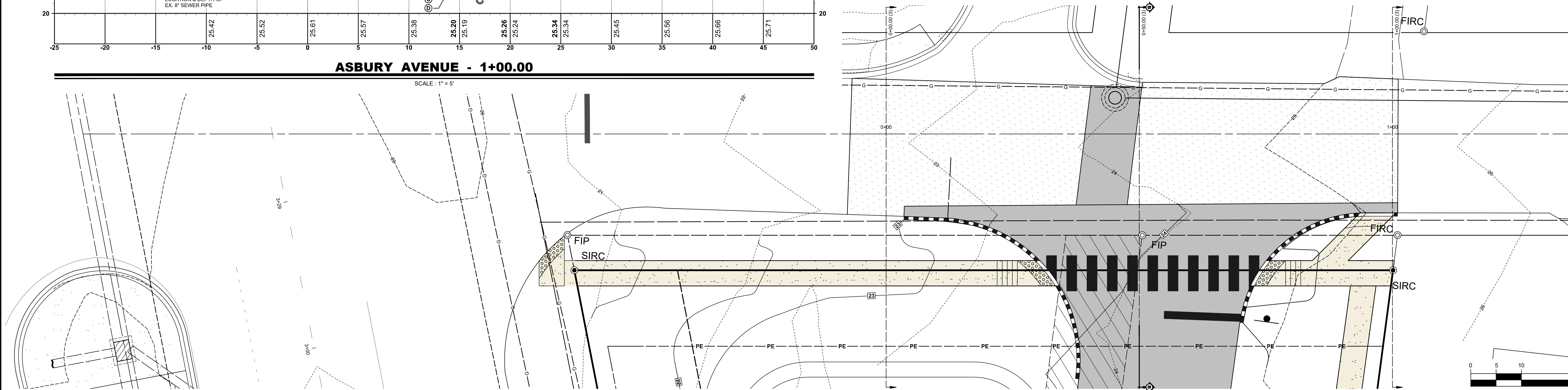

ASBURY AVENUE ENTRANCE CROSS SECTION PLAN

SCALE: 1" = 10'

PROJECT TITLE

**DOLLAR
GENERAL
CAMDEN**

2035 SOUTH DUPONT HIGHWAY
TOWN OF CAMDEN
KENT COUNTY, DELAWARE

SHEET TITLE

**ENTRANCE PLANS:
CROSS SECTIONS -
ASBURY AVENUE**

ISSUE BLOCK

NO.	DATE	DESCRIPTION
3.	5/4/20	REVISED PER KCD COMMENTS DATED 4/15/20
2.	4/30/20	REVISED PER DELDOT COMMENTS DATED 4/3/20
1.	3/6/20	REVISED PER KENT COUNTY PUBLIC WORK COMMENTS DATED 3/4/20

MARK DATE DESCRIPTION

LAYER/STATE: C-610

PROJECT NO.: 2019207.00

DATE: 1/27/20

SCALE: AS SHOWN

DRAWN BY: J.D.K. | PROJ. MGR.: J.N.S.

SHEET

C-610

COPYRIGHT 2019

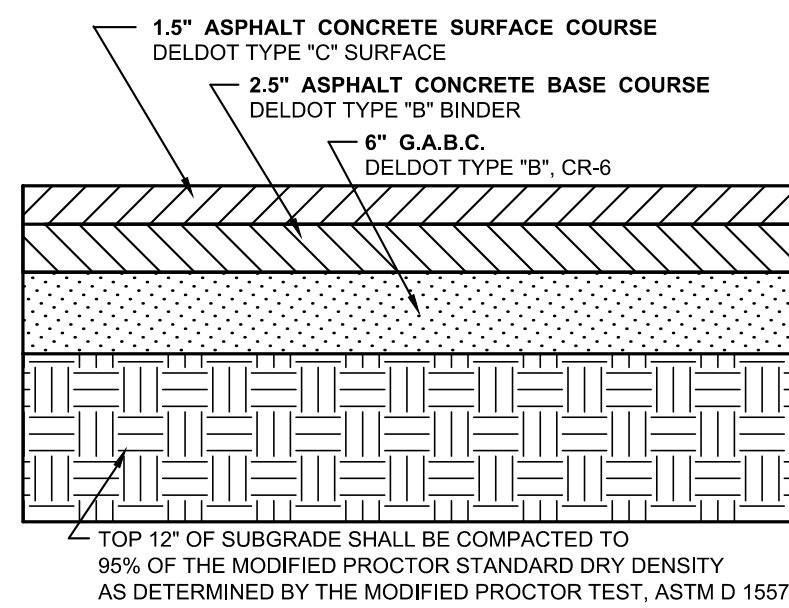

PAVEMENT SECTION DETAIL
NO SCALE BMG NO.: SW-2A

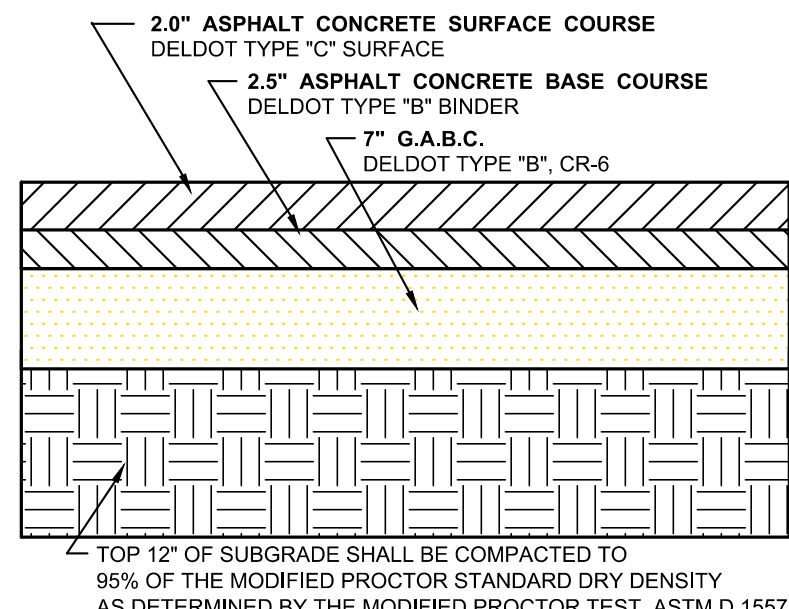

HEAVY DUTY PAVEMENT SECTION DETAIL
NO SCALE BMG NO.: SW-2A

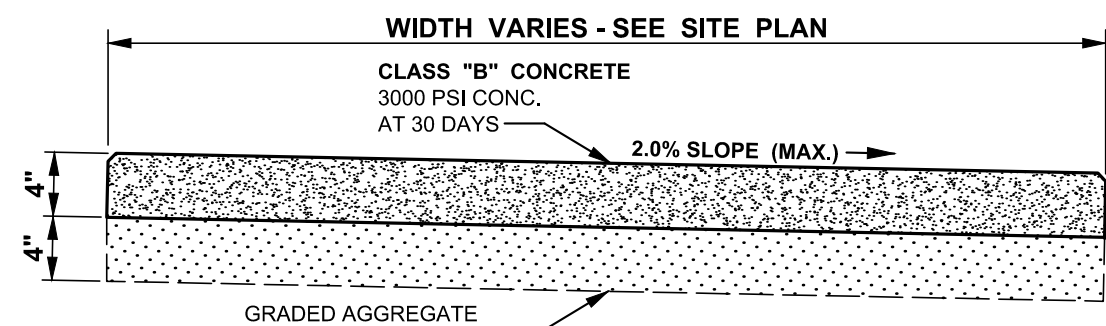

CONCRETE SIDEWALK DETAIL
NO SCALE BMG NO.: SW-03C

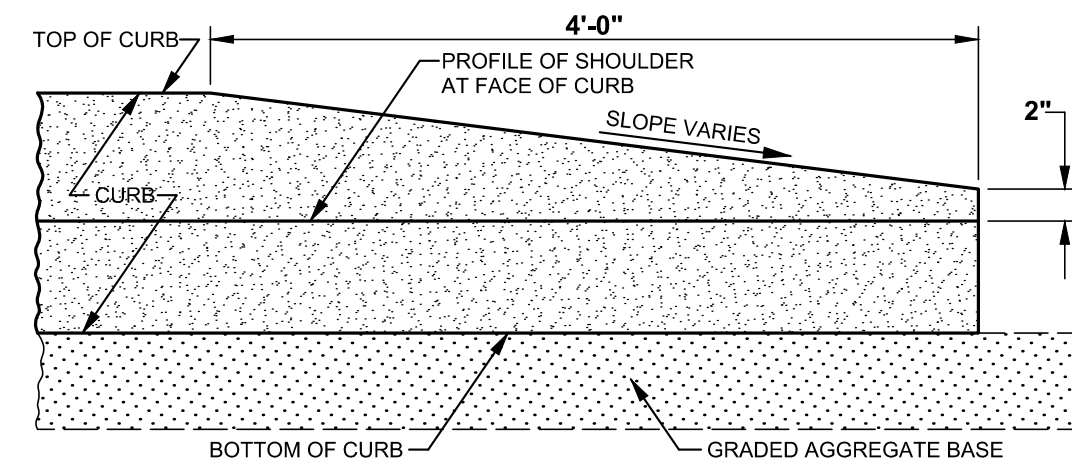

CURB TAPER DETAIL
NO SCALE DELODOT ACCESS MANUAL - PAGE 4-3 BMG NO.: SW-10C

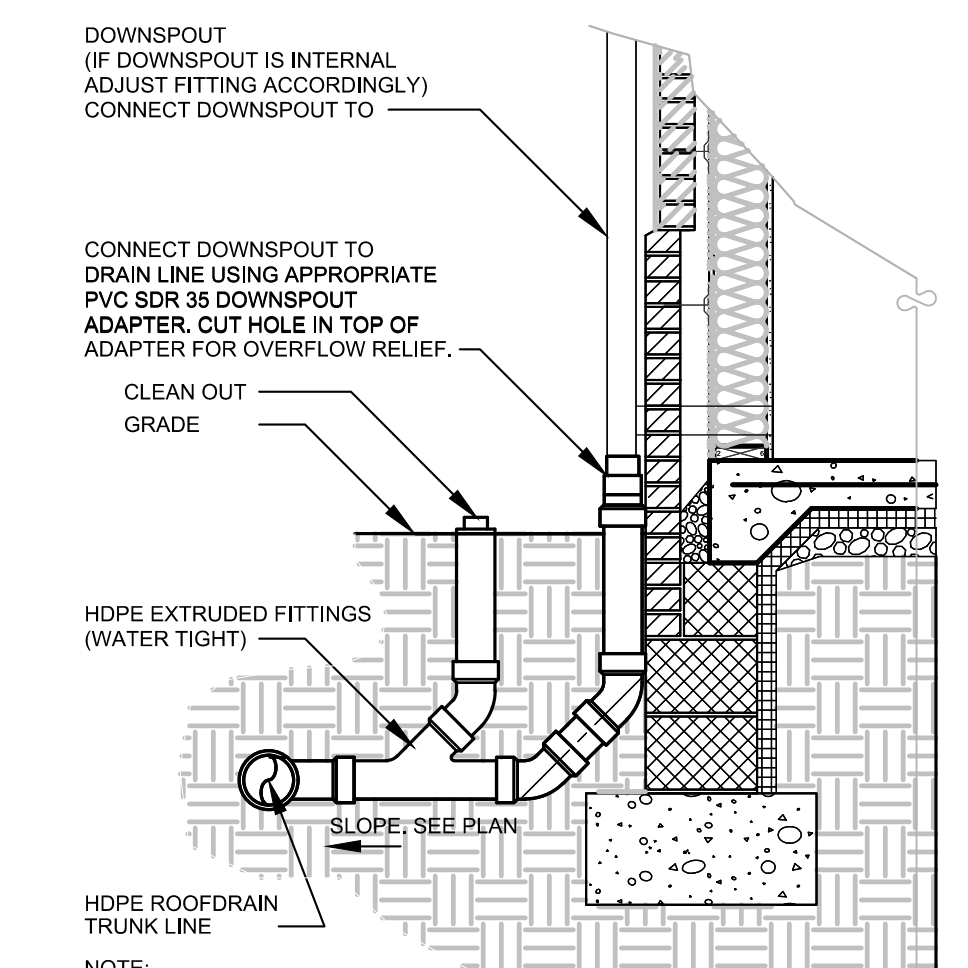

DOWNSPOUT BOOT DETAIL
NO SCALE

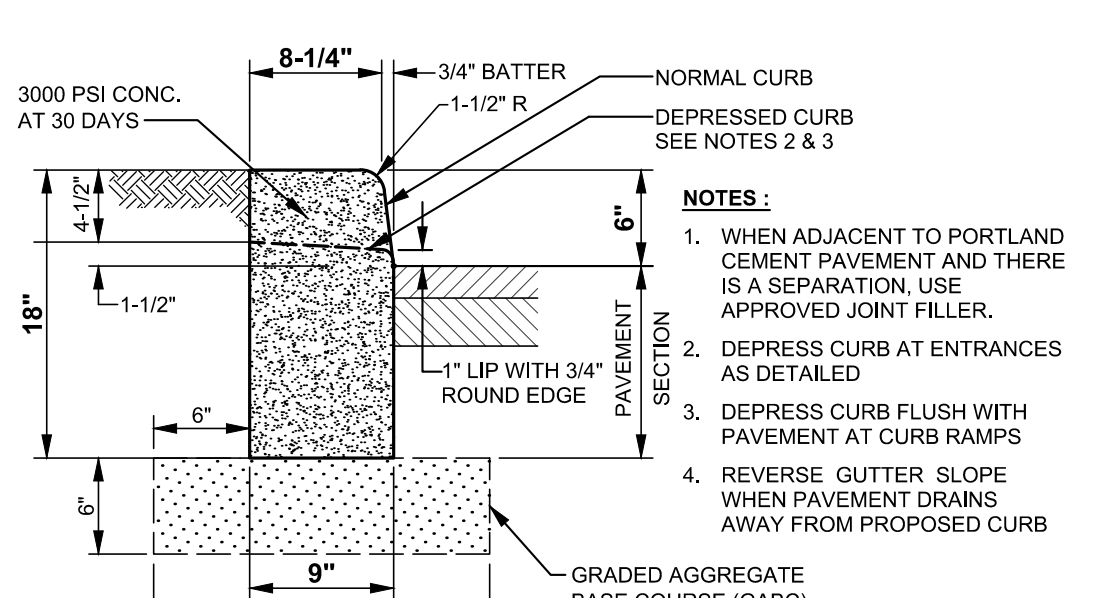

P.C.C. CURB - TYPE 1-6
NO SCALE SHOWN FOR REFERENCE ONLY - SEE DELDOT STANDARDS BMG NO.: SW-011A

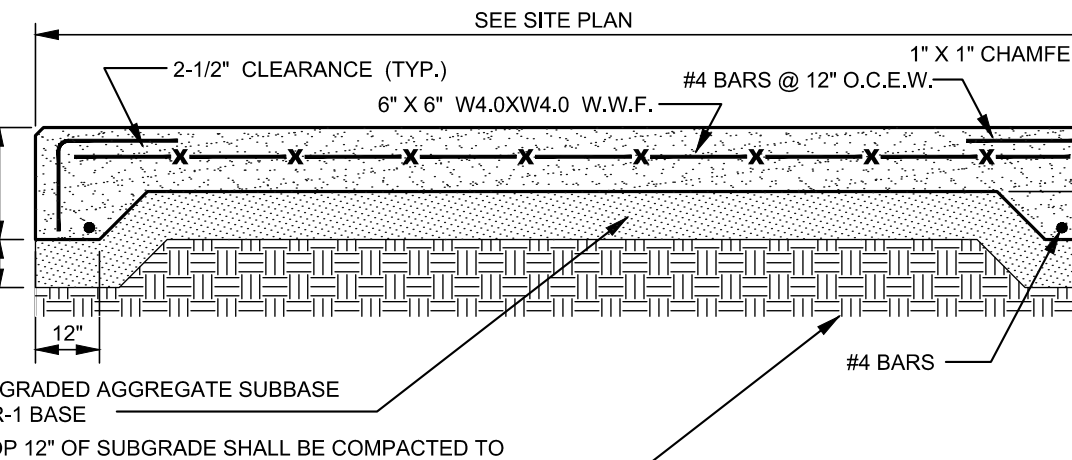

LOADING RAMP PAD DETAIL
NO SCALE BMG NO.: SW-6A

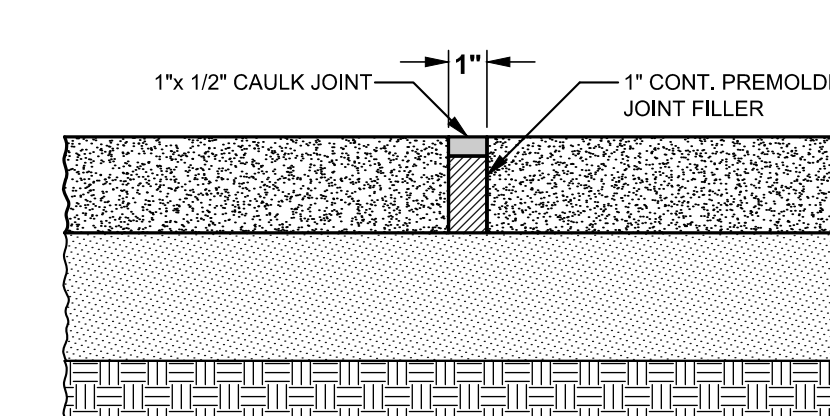

CONSTRUCTION / EXPANSION JOINT DETAIL
NO SCALE BMG NO.: SW-6F

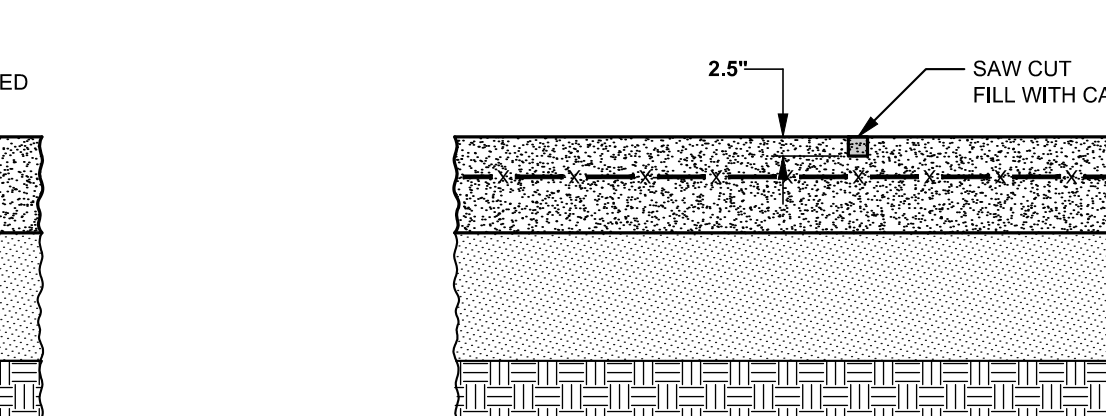

CONTROL JOINT DETAIL
NO SCALE BMG NO.: SW-8E

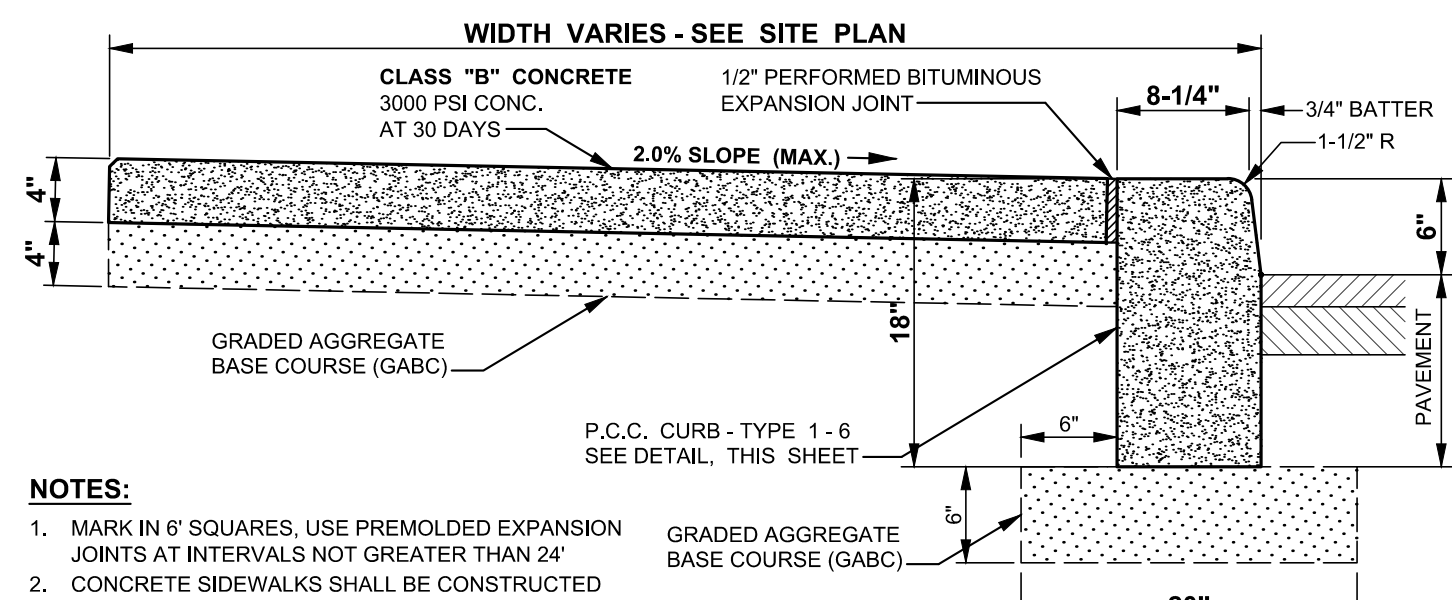

COMBINATION SIDEWALK AND P.C.C. CURB TYPE 1-6
NO SCALE BMG NO.: SW-03I

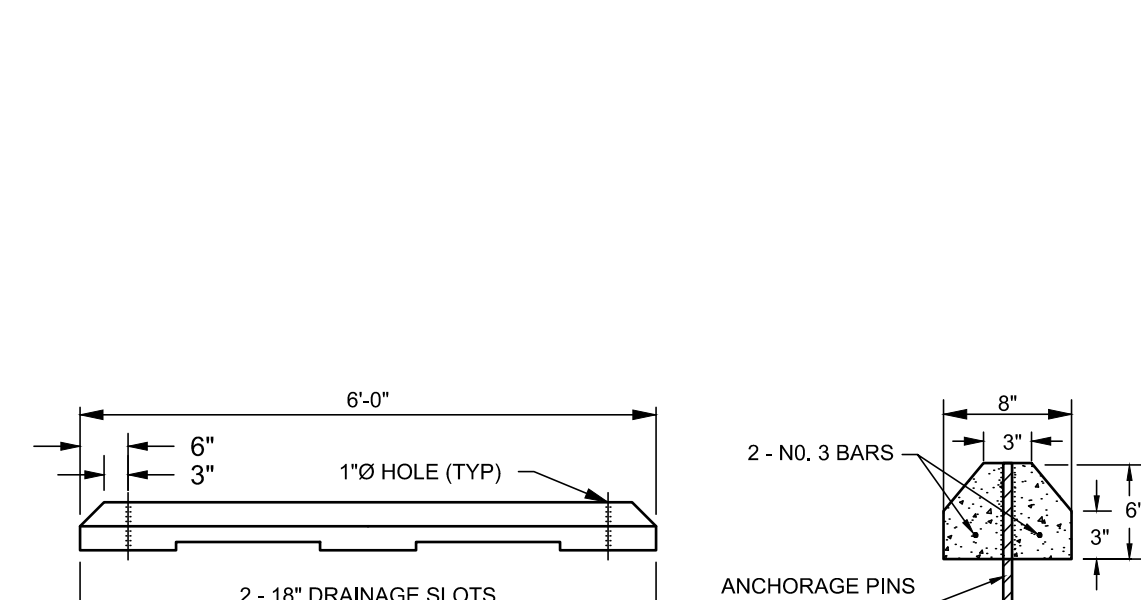

PRECAST CONCRETE BUMPER BLOCKS
NO SCALE BMG NO.: SW-14

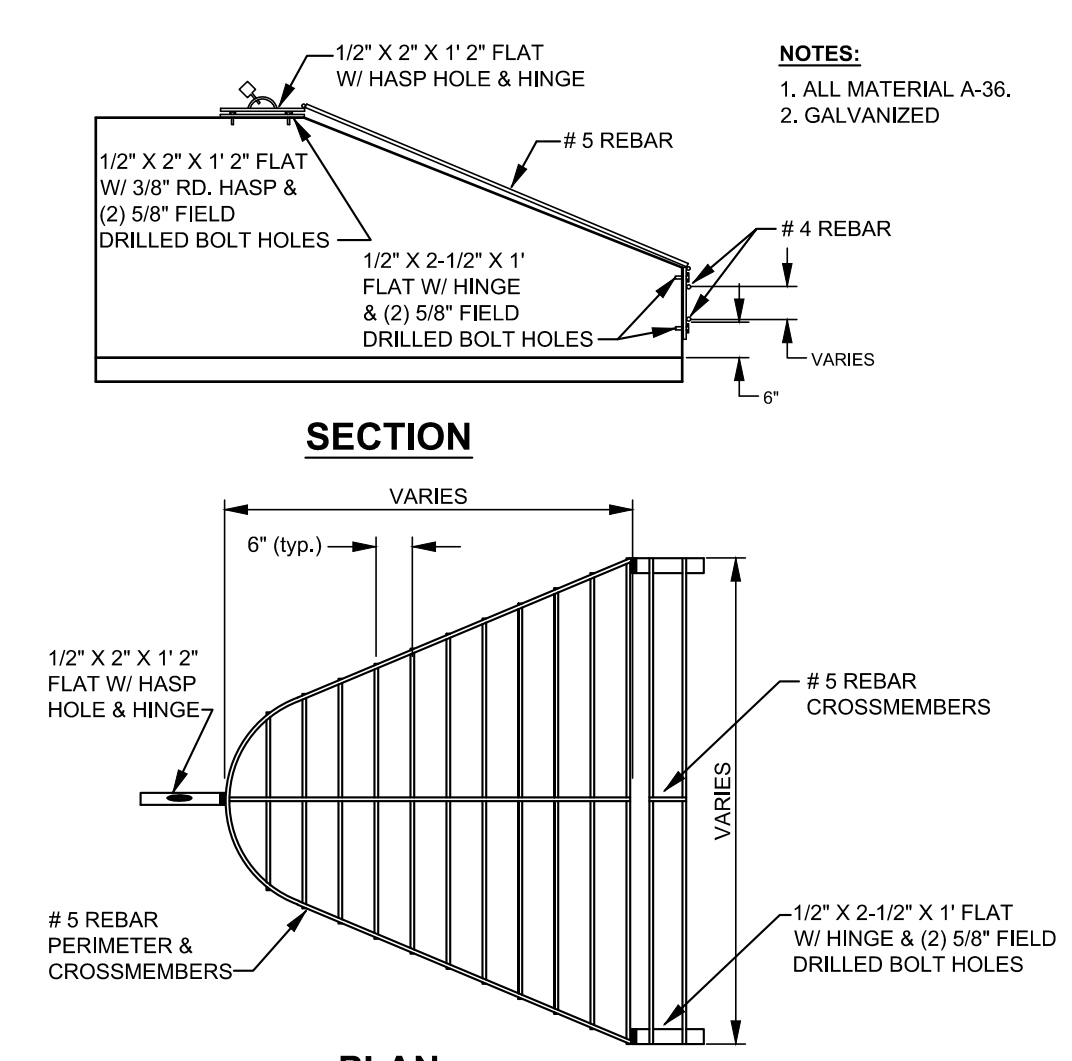

FLARED END SECTION CHILD SAFETY RACK
NO SCALE BMG NO.: SD-09A

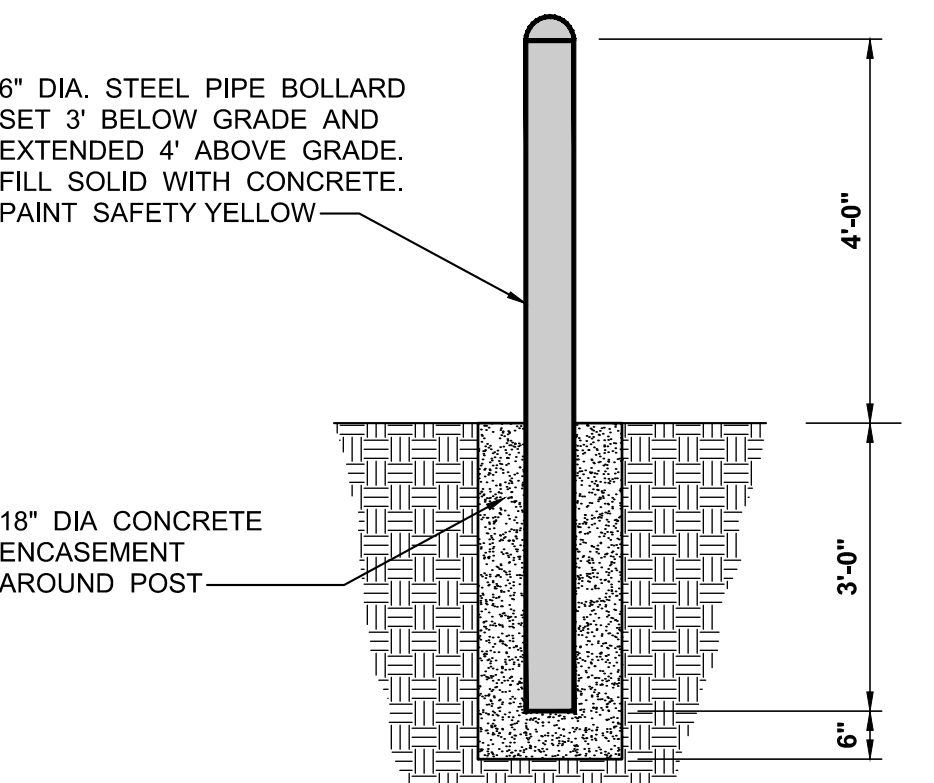

PIPE BOLLARD DETAIL
NO SCALE BMG NO.: SW-9A

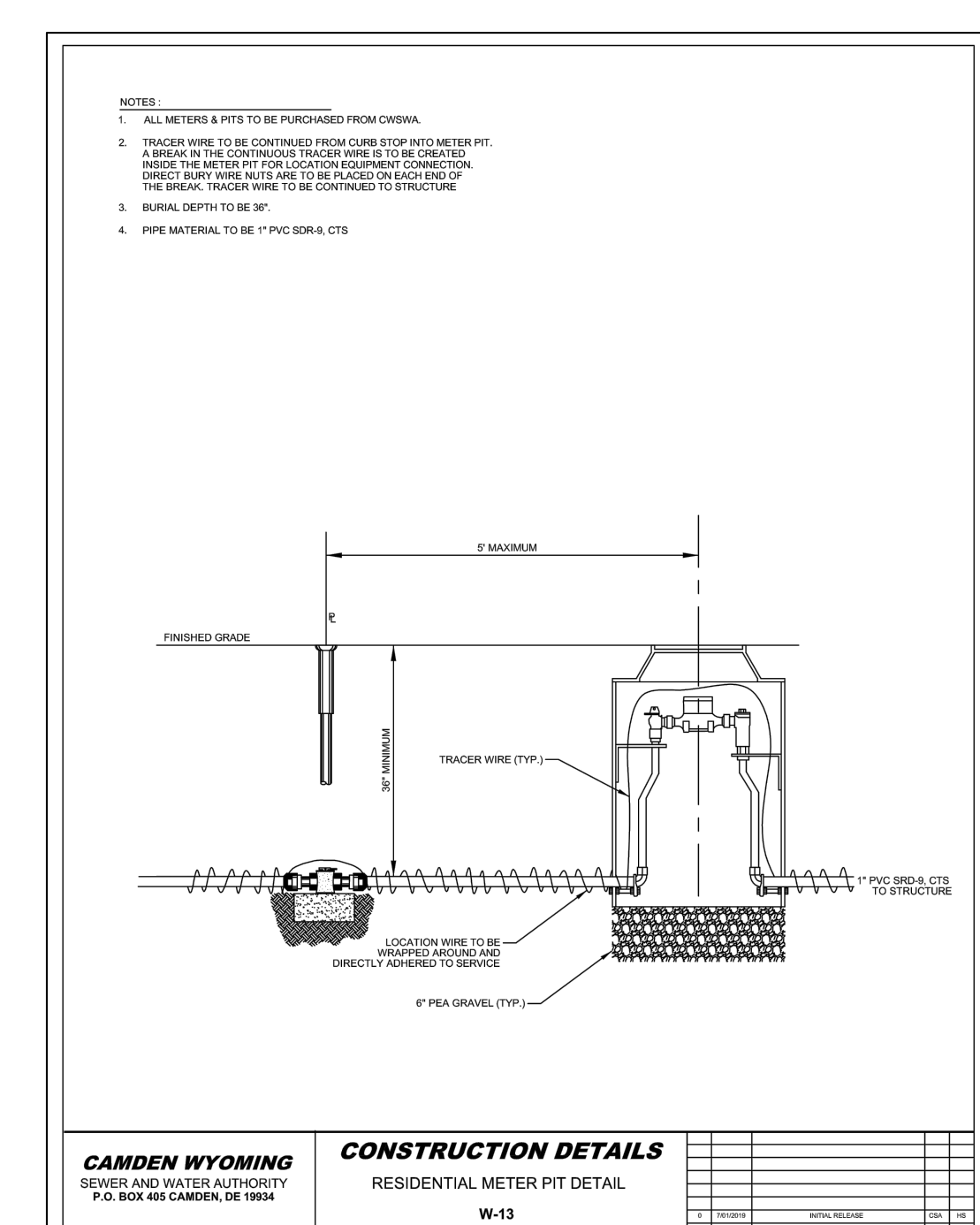

CAMDEN WYOMING CONSTRUCTION DETAILS RESIDENTIAL METER PIT DETAIL
W-13

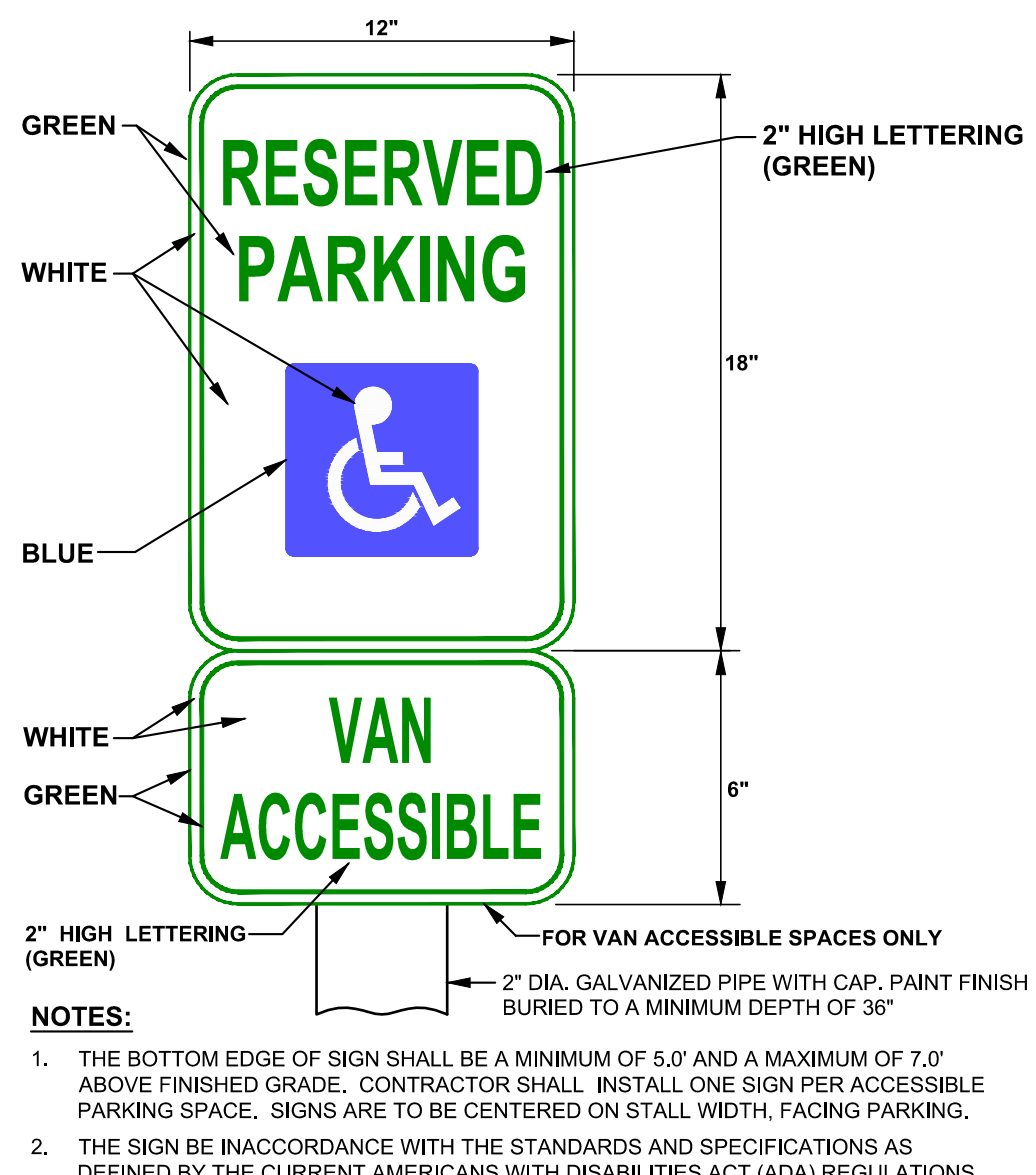

ACCESSIBLE PARKING SIGN DETAIL
NO SCALE BMG NO.: SW-4CB-VAN

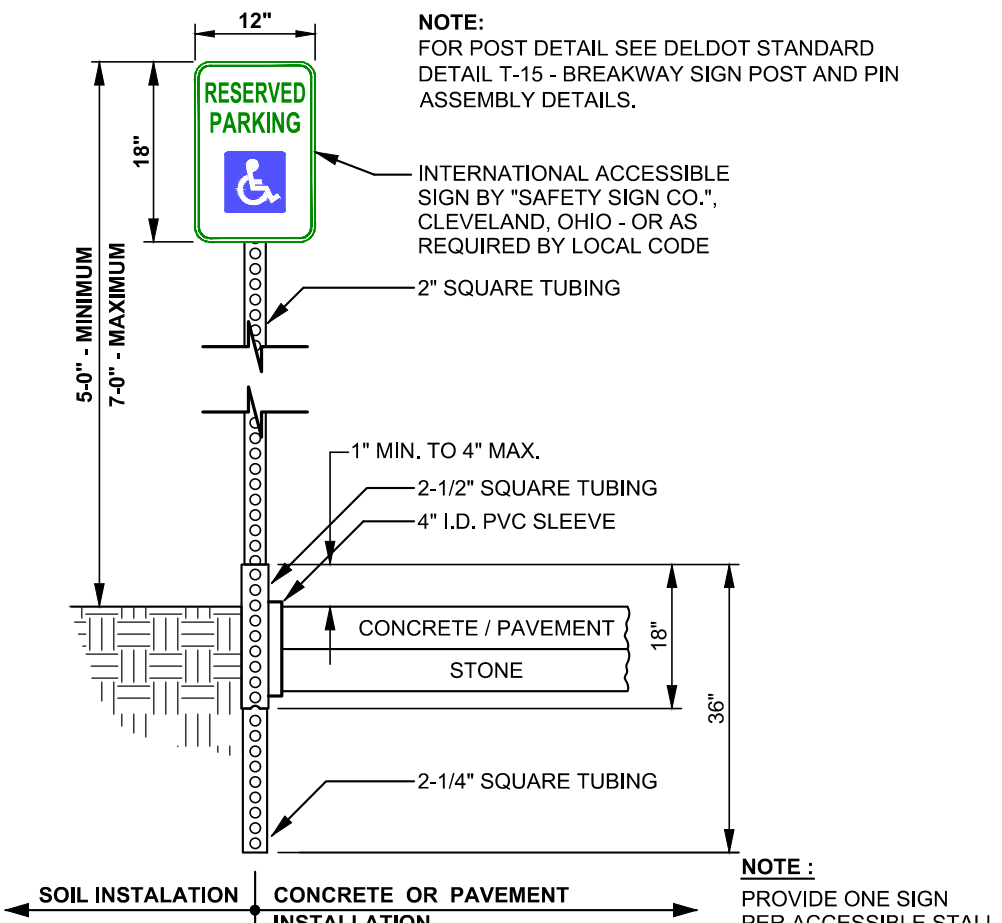

ACCESSIBLE PARKING SIGN & POLE
NO SCALE BMG NO.: SW-4D



ACCESSIBLE THERMO SYMBOL
NO SCALE BMG NO.: SW-4E-2

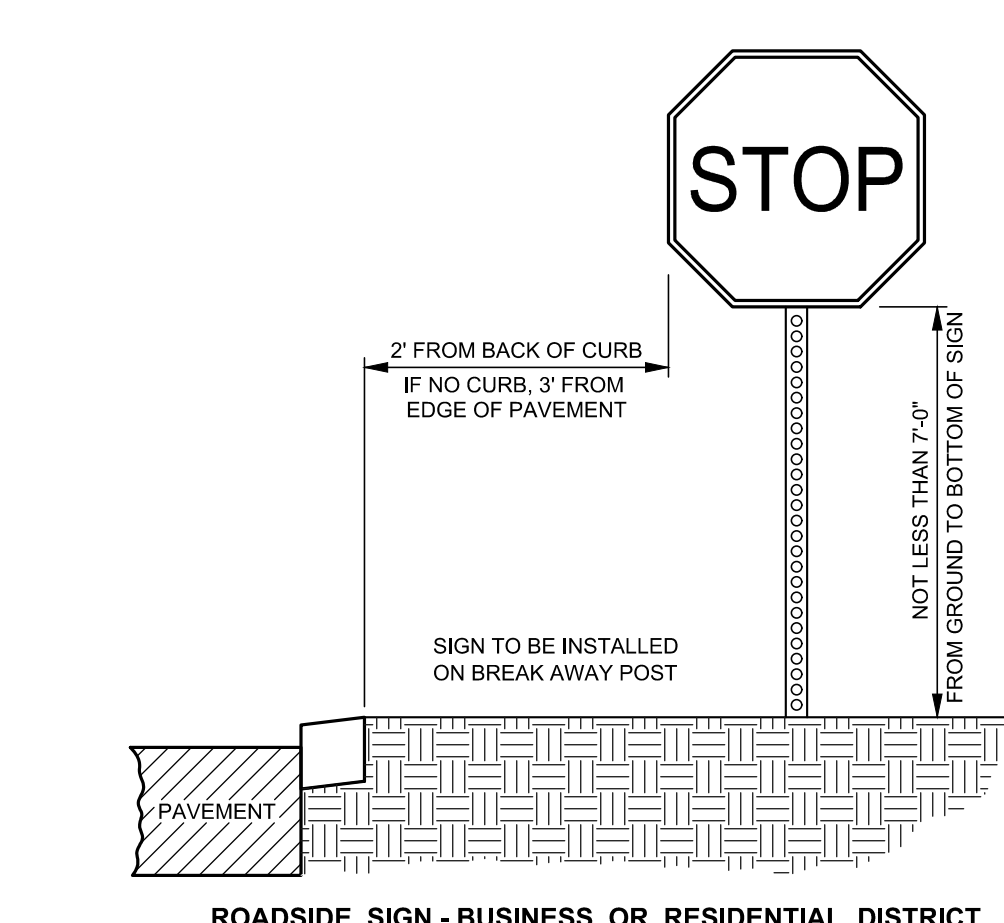

ROADSIDE SIGN - BUSINESS OR RESIDENTIAL DISTRICT
NO SCALE

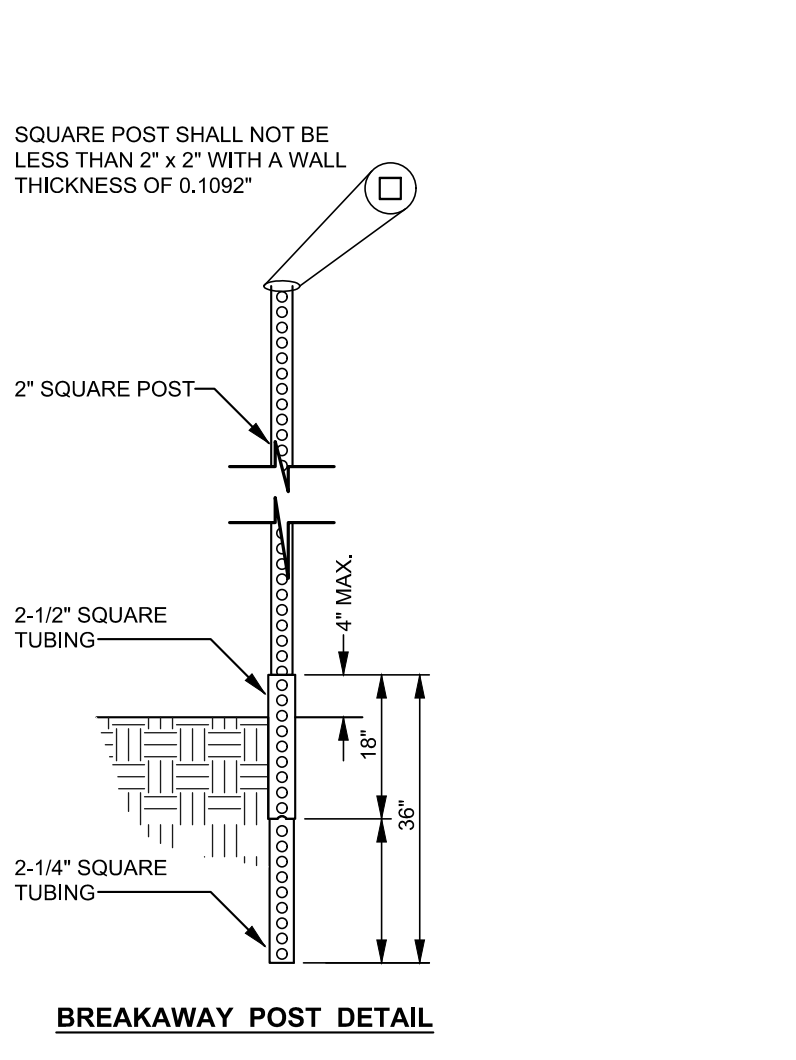

STOP SIGN AND BREAKAWAY POST DETAIL
NO SCALE BMG NO.: TS-02R

PROJECT TITLE
DOLLAR GENERAL CAMDEN

2035 SOUTH DUPONT HIGHWAY
TOWN OF CAMDEN
KENT COUNTY, DELAWARE

SHEET TITLE
CONSTRUCTION DETAILS

MARK	DATE	DESCRIPTION
3.	4/21/20	REVISED PER KCD COMMENTS DATED 4/15/20
2.	4/6/20	REVISED PER DELDOT COMMENTS DATED 4/3/20
1.	3/6/20	REVISED PER KENT COUNTY PUBLIC WORKS COMMENTS DATED 3/4/20

PROJECT NO.: 2019207.00
DATE: 10/23/2019
SCALE: AS SHOWN
DRAWN BY: J.D.K. | PROJ. MGR.: J.N.S.

SHEET
C-901
COPYRIGHT 2019

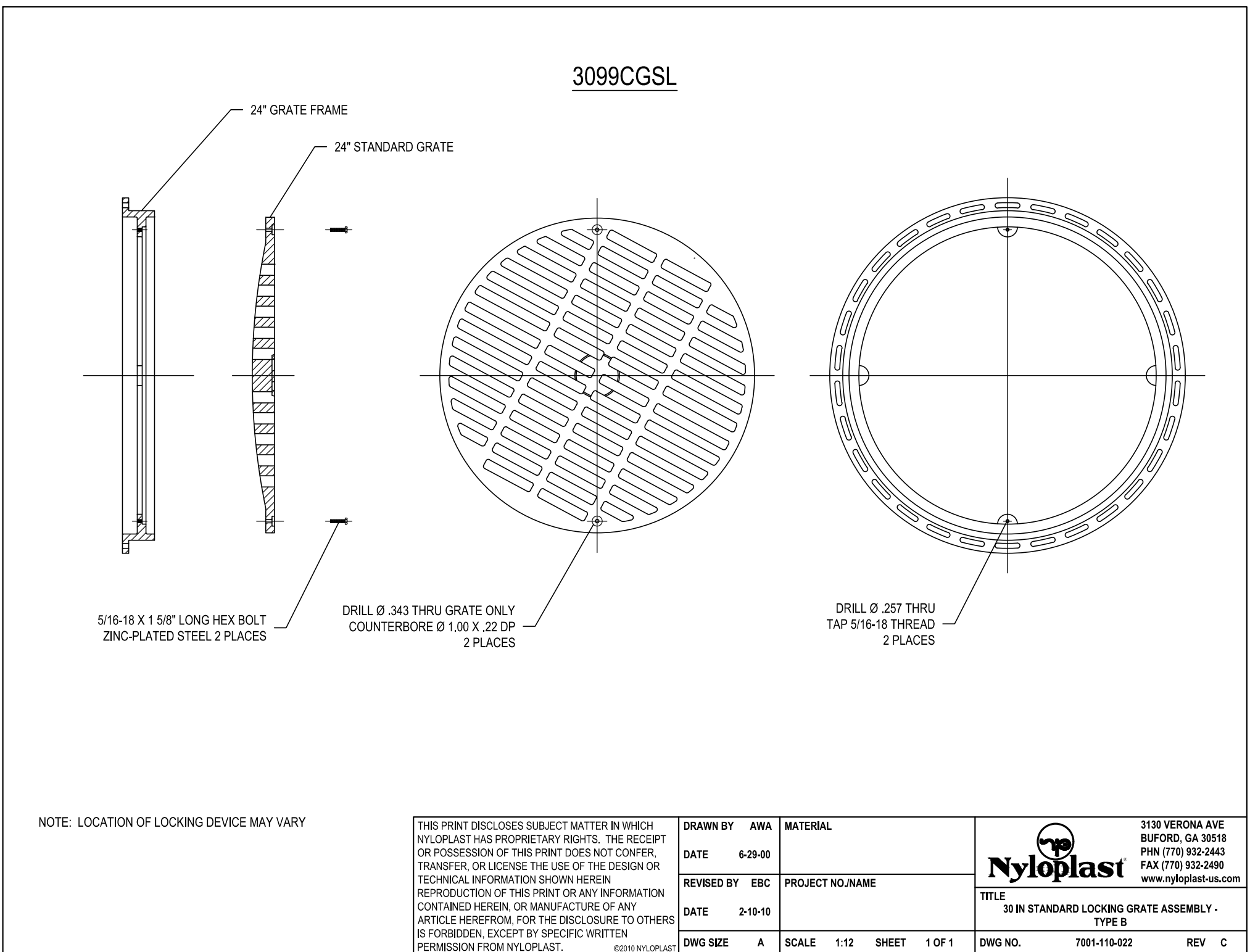
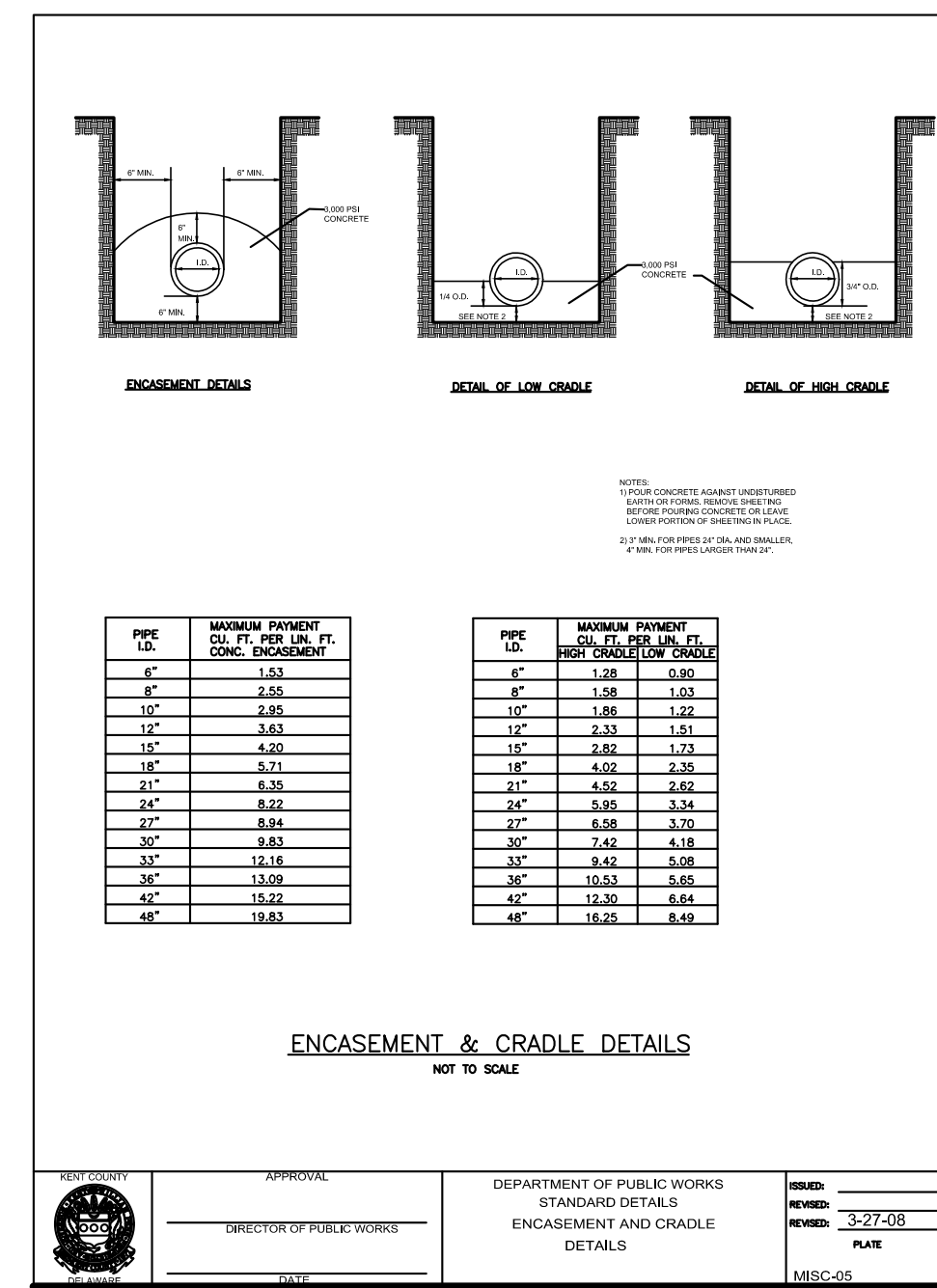
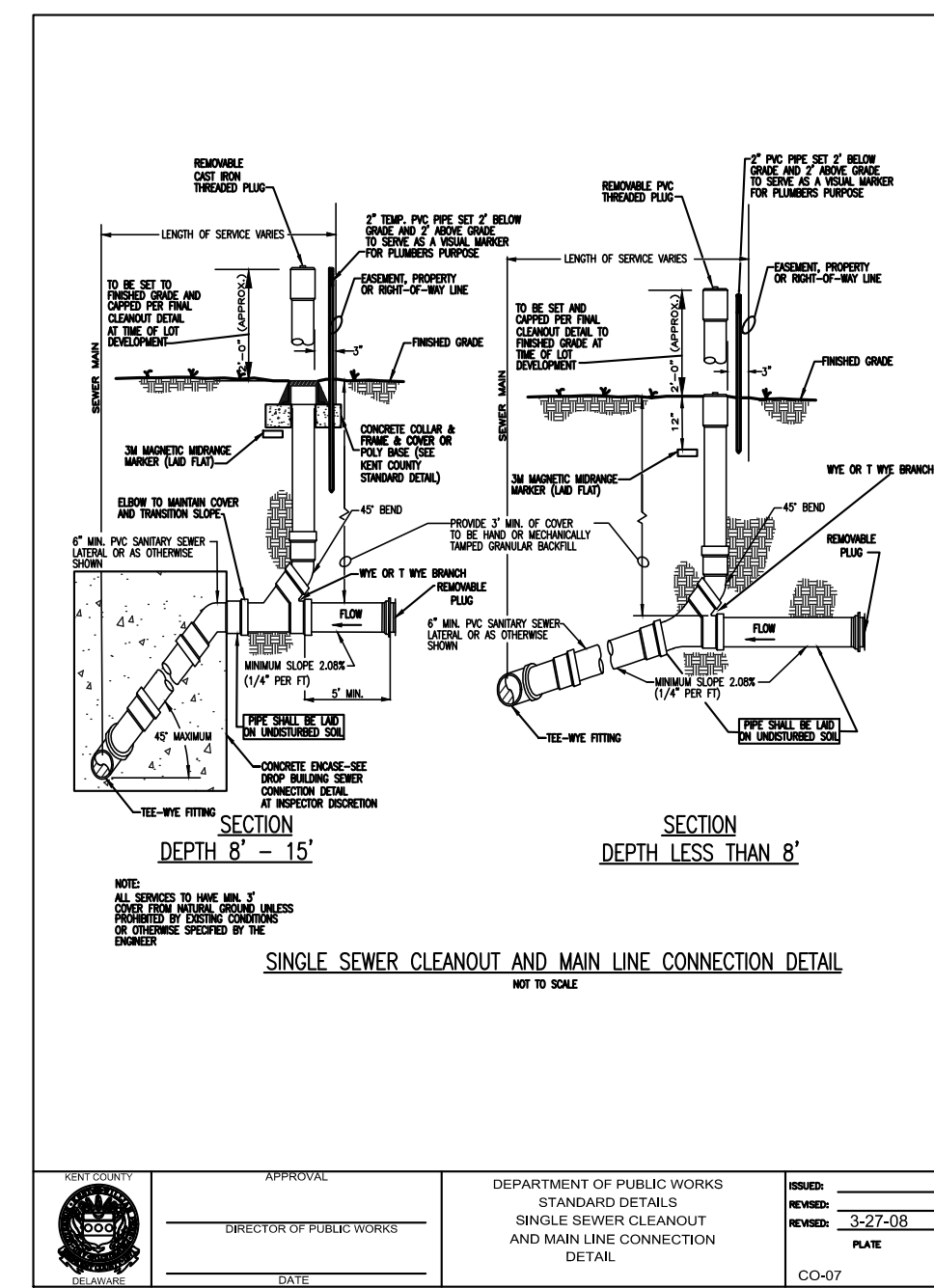
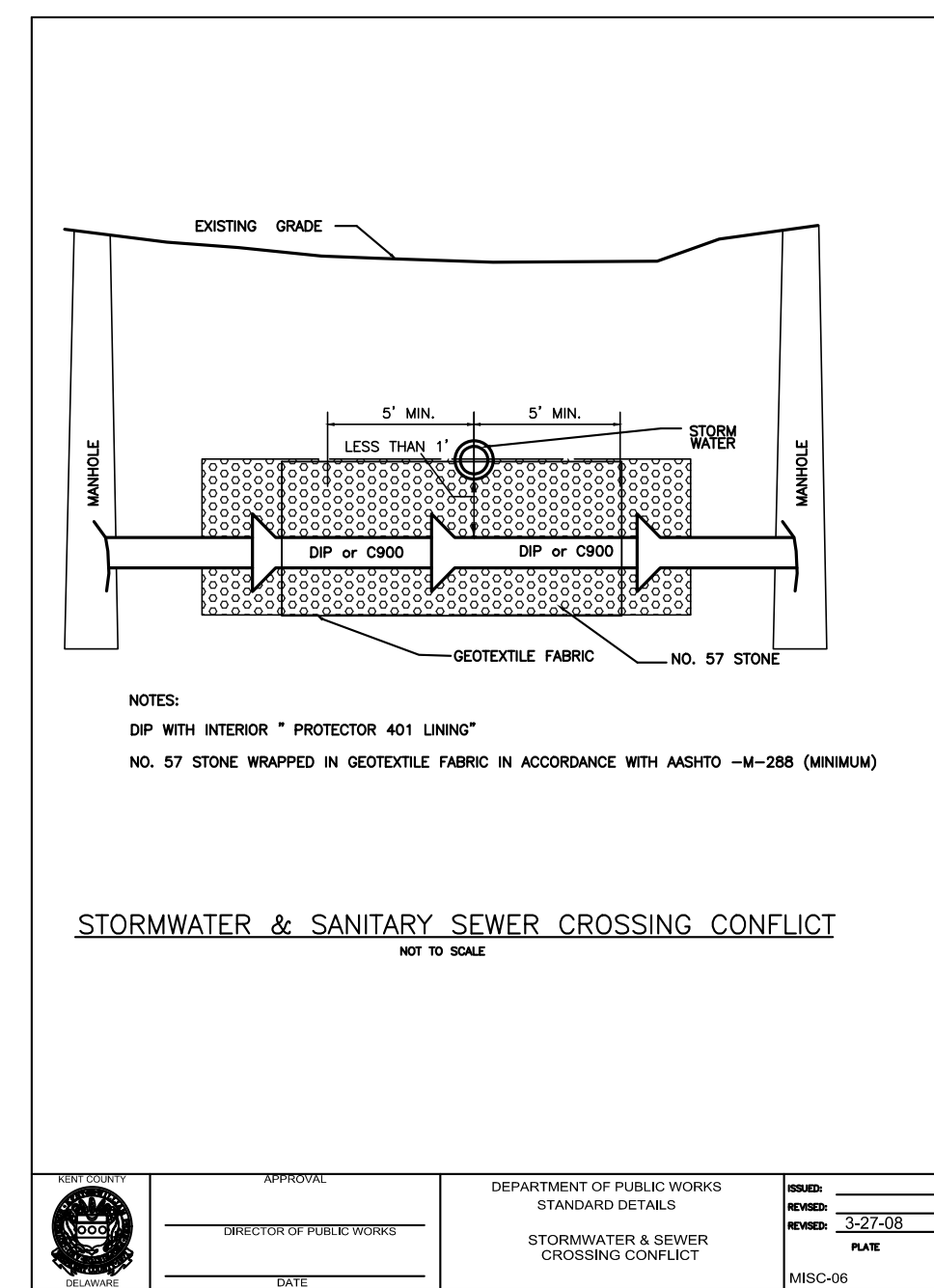
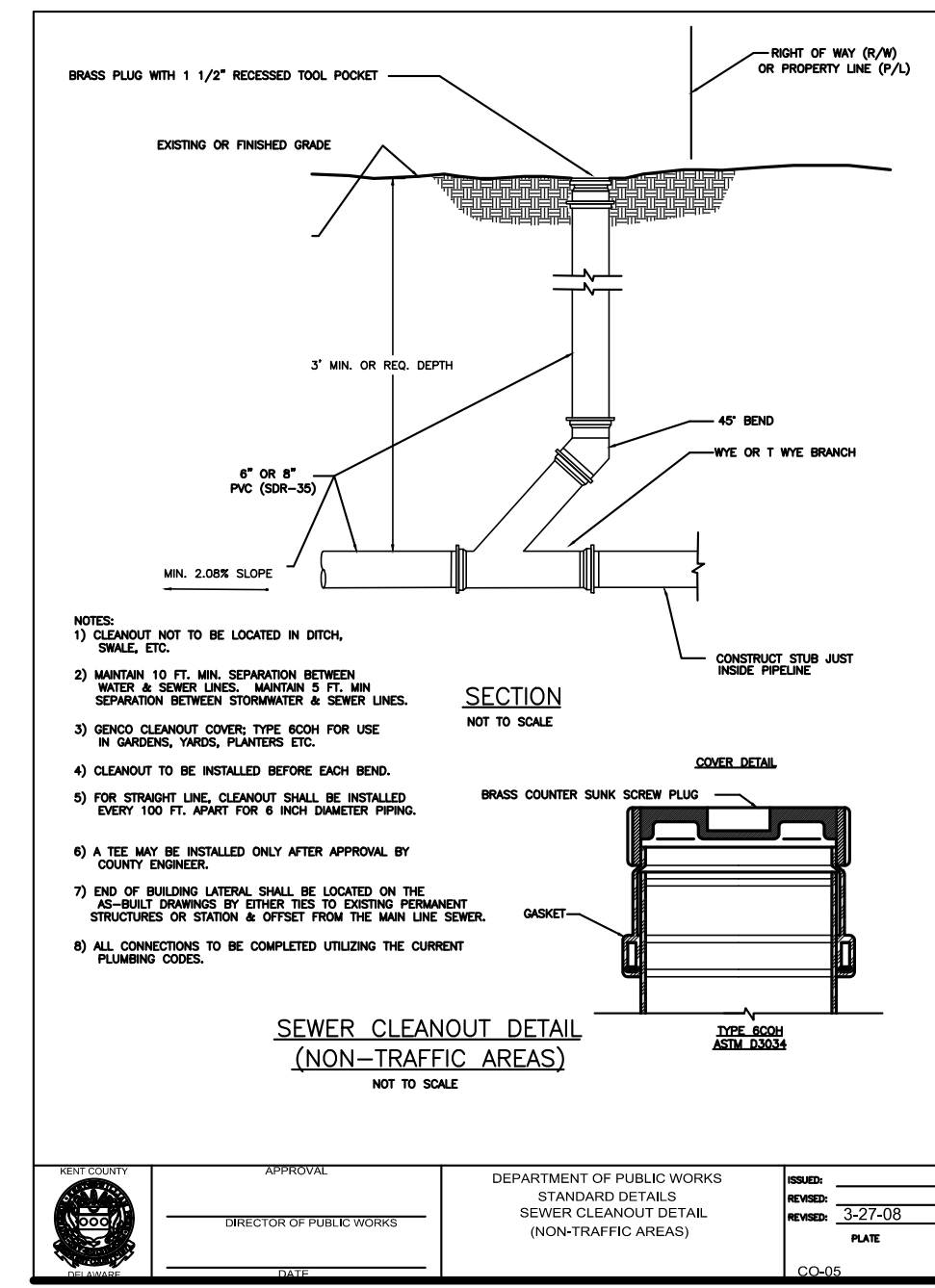
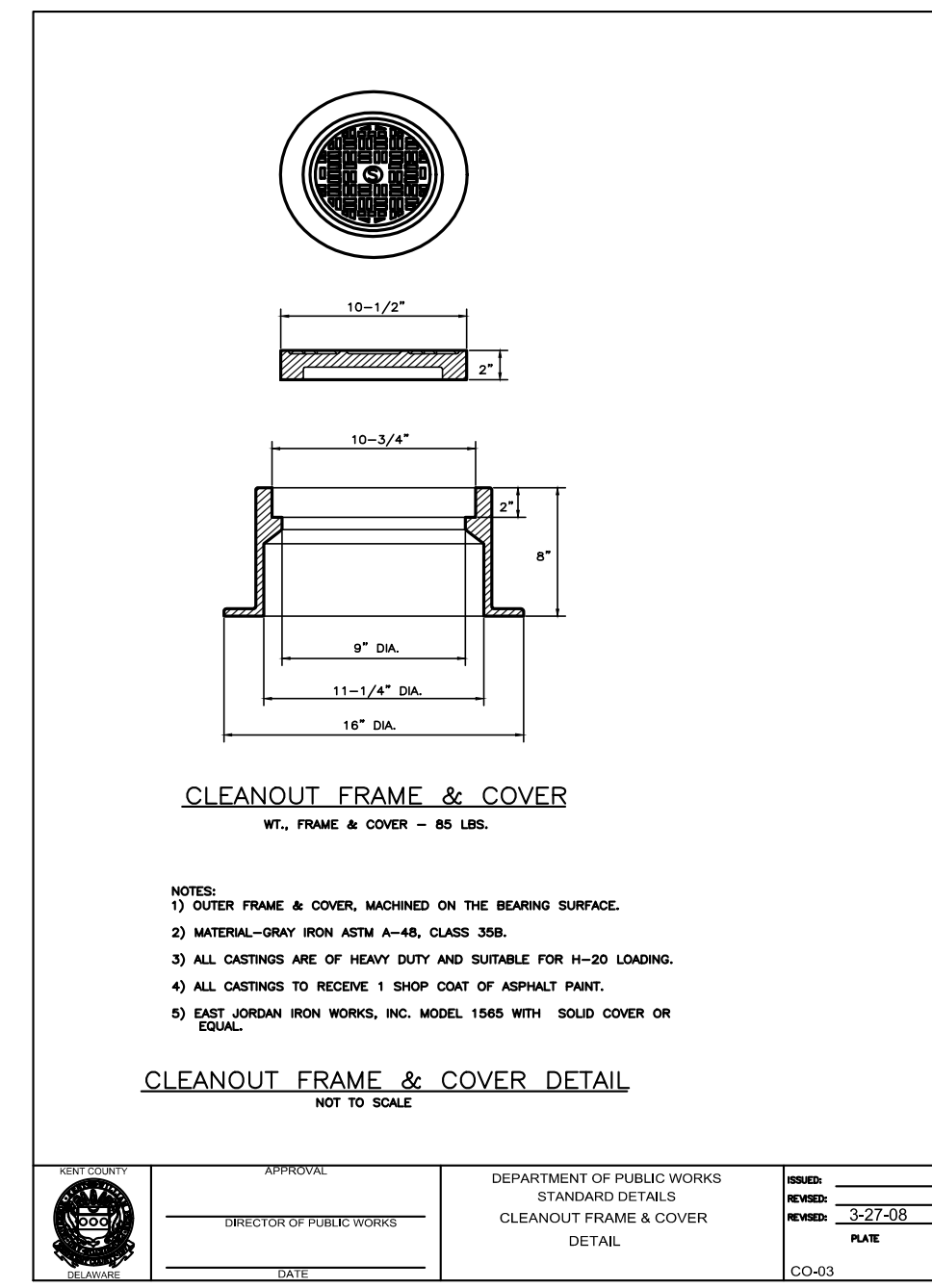

NYLOPLAST 24 INCH STANDARD LOCKING GRATE - TYPE B
NO SCALE

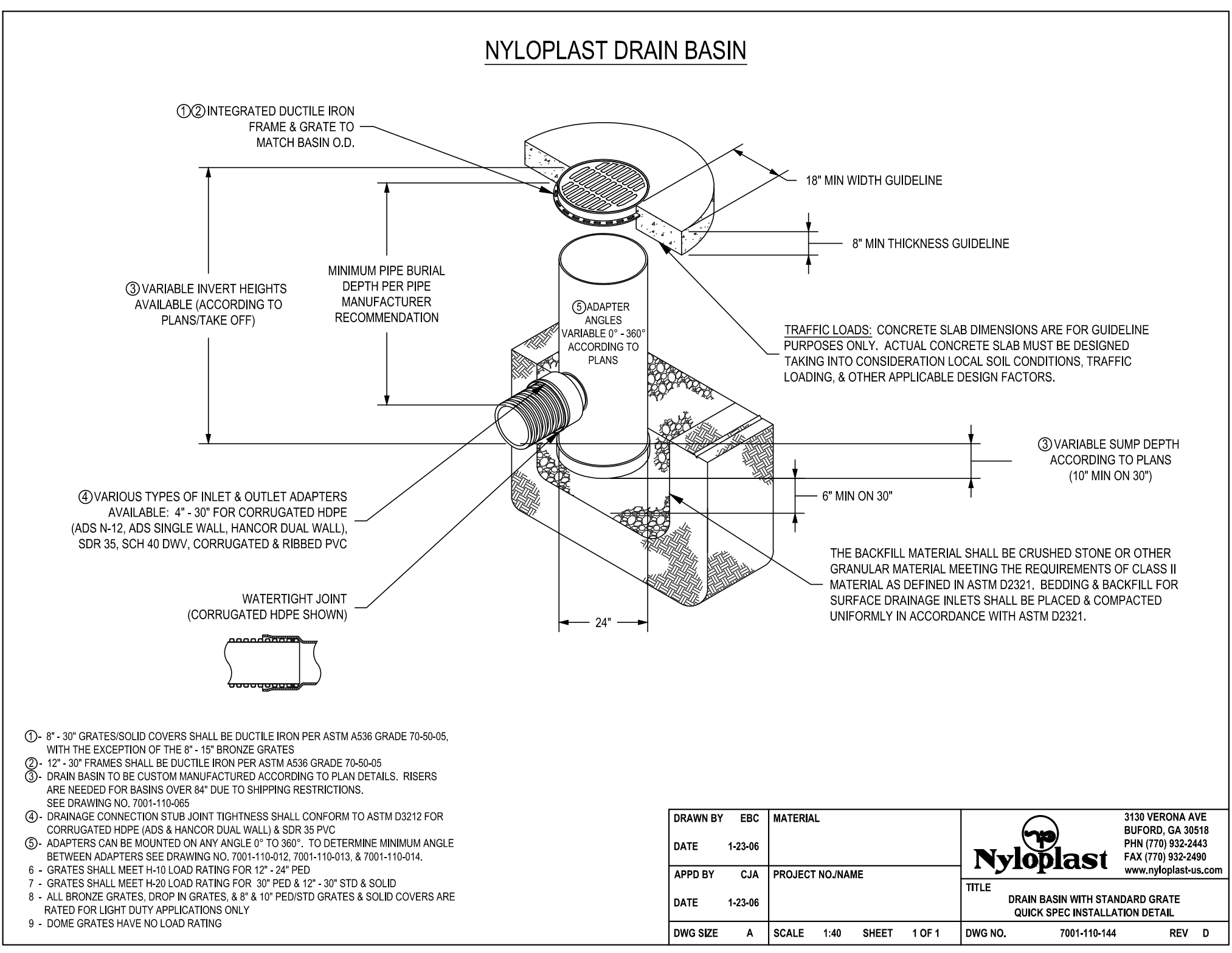

NYLOPLAST DRAIN BASIN DETAIL
NO SCALE

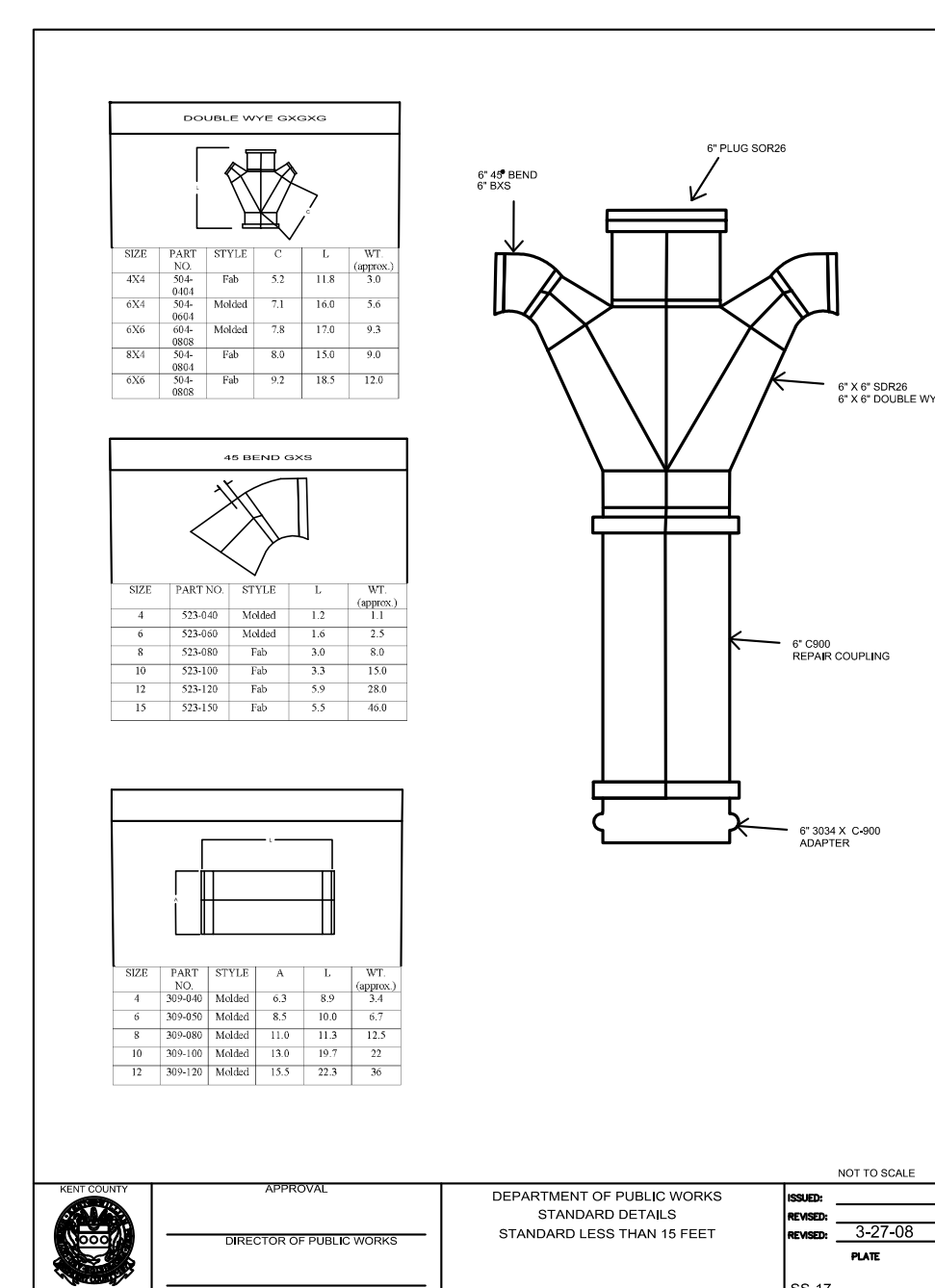
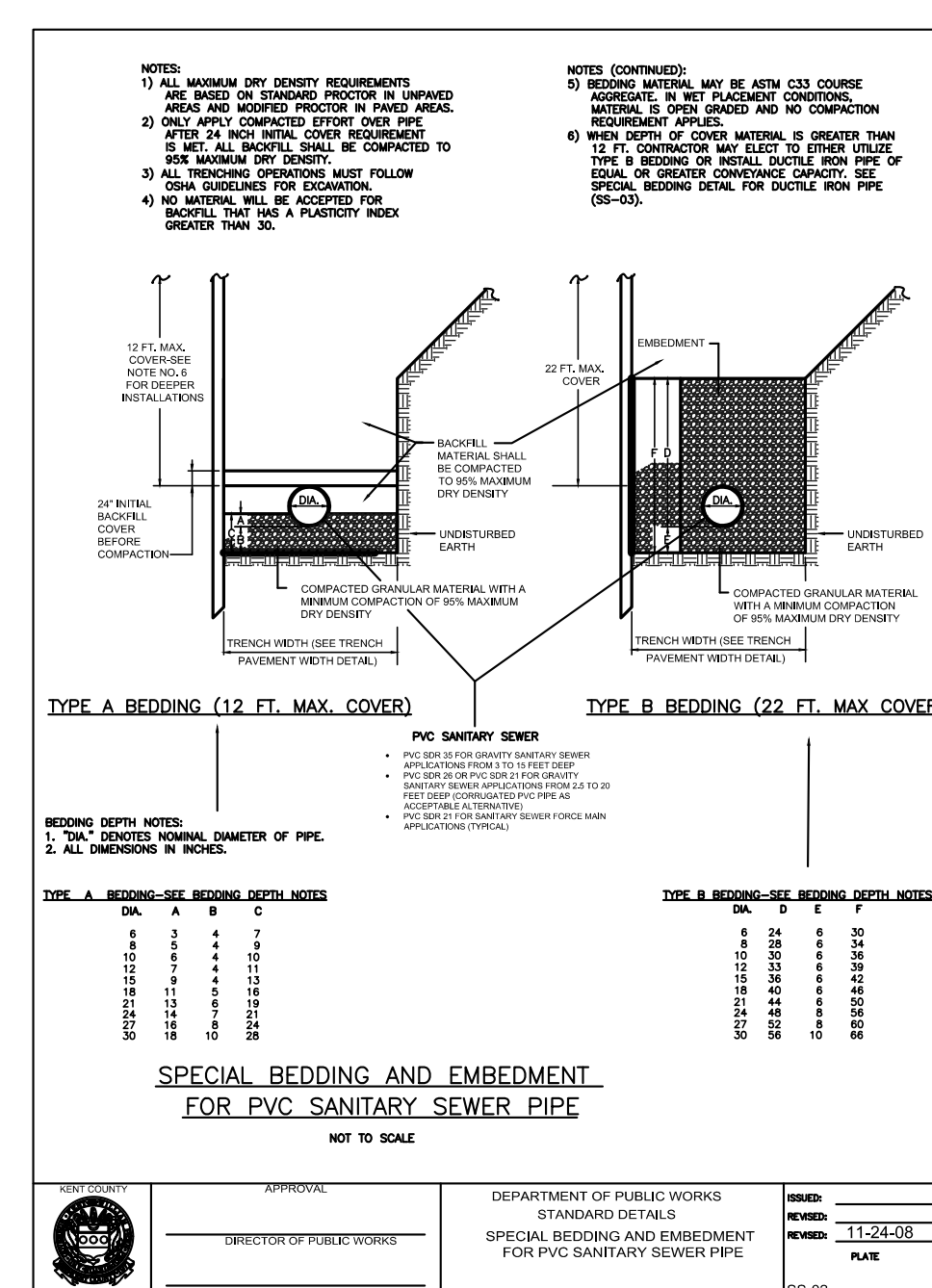
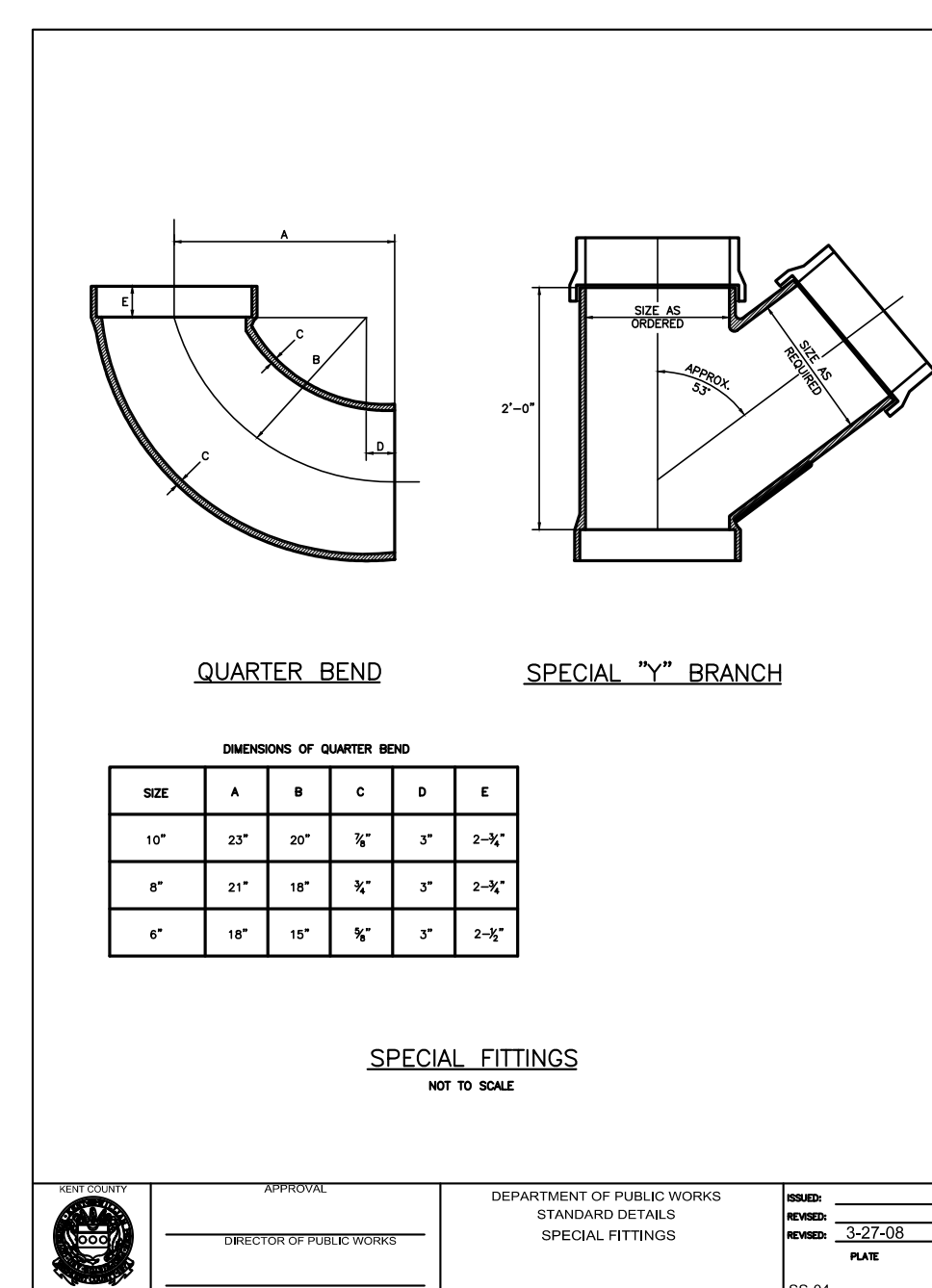

PROJECT TITLE

DOLLAR GENERAL CAMDEN

2035 SOUTH DUPONT HIGHWAY
TOWN OF CAMDEN
KENT COUNTY, DELAWARE

SHEET TITLE

CONSTRUCTION DETAILS

ISSUE BLOCK

NO.	DATE	REVISION
3.	4/21/20	REVISED PER KCD COMMENTS DATED 4/15/20
2.	4/6/20	REVISED PER DELDOT COMMENTS DATED 4/3/20
1.	3/6/20	REVISED PER KENT COUNTY PUBLIC WORKS COMMENTS DATED 3/4/20

MARK	DATE	DESCRIPTION
LAYER STATE	C-902	

PROJECT NO.: 2019207.00
DATE: 10/23/2019
SCALE: AS SHOWN
DRAWN BY: J.D.K. / PROJ. MGR.: J.N.S.

SHEET
C-902
COPYRIGHT 2019

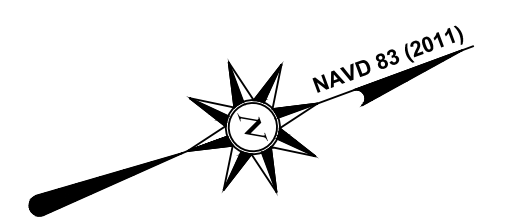

PROJECT TITLE

**DOLLAR GENERAL
CAMDEN**

2035 SOUTH DUPONT HIGHWAY
TOWN OF CAMDEN
KENT COUNTY, DELAWARE

SHEET TITLE

LANDSCAPE PLAN

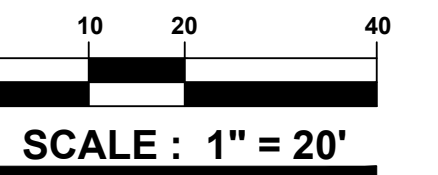

ISSUE BLOCK

MARK	DATE	DESCRIPTION

PROJECT NO.: 2019207.00

DATE: 10/23/2019

SCALE: 1" = 20'

DRAWN BY: J.M.P. | PROJ. MGR.: J.N.S.

SHEET

L-101

COPYRIGHT: 2019

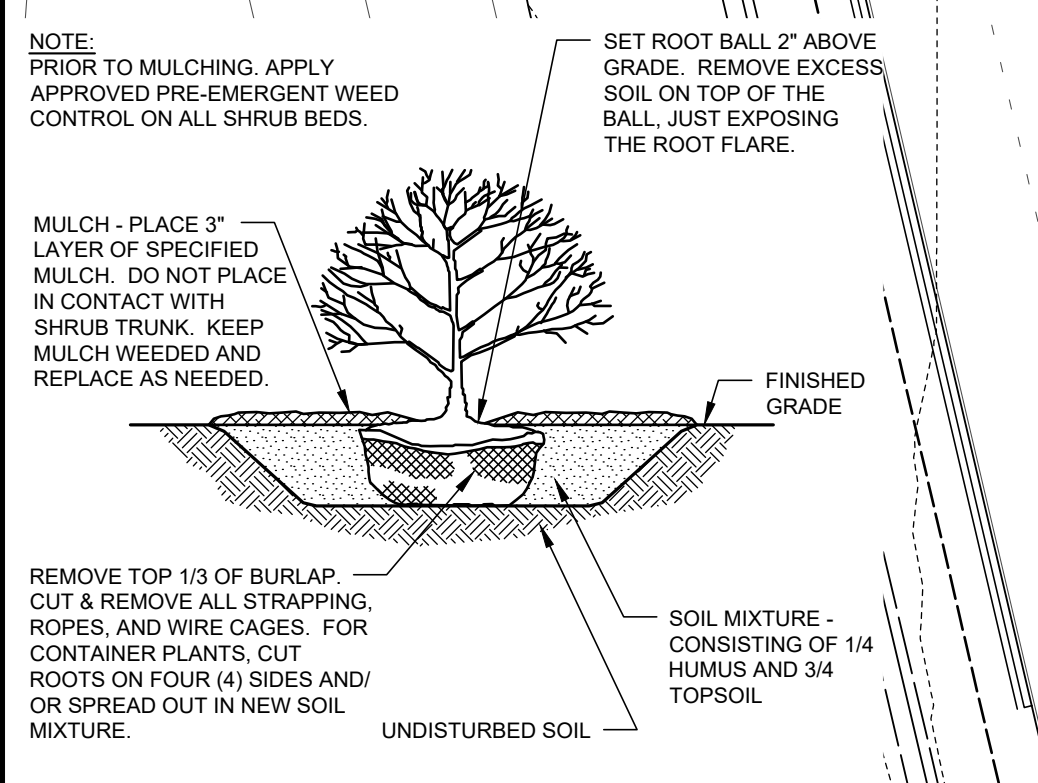
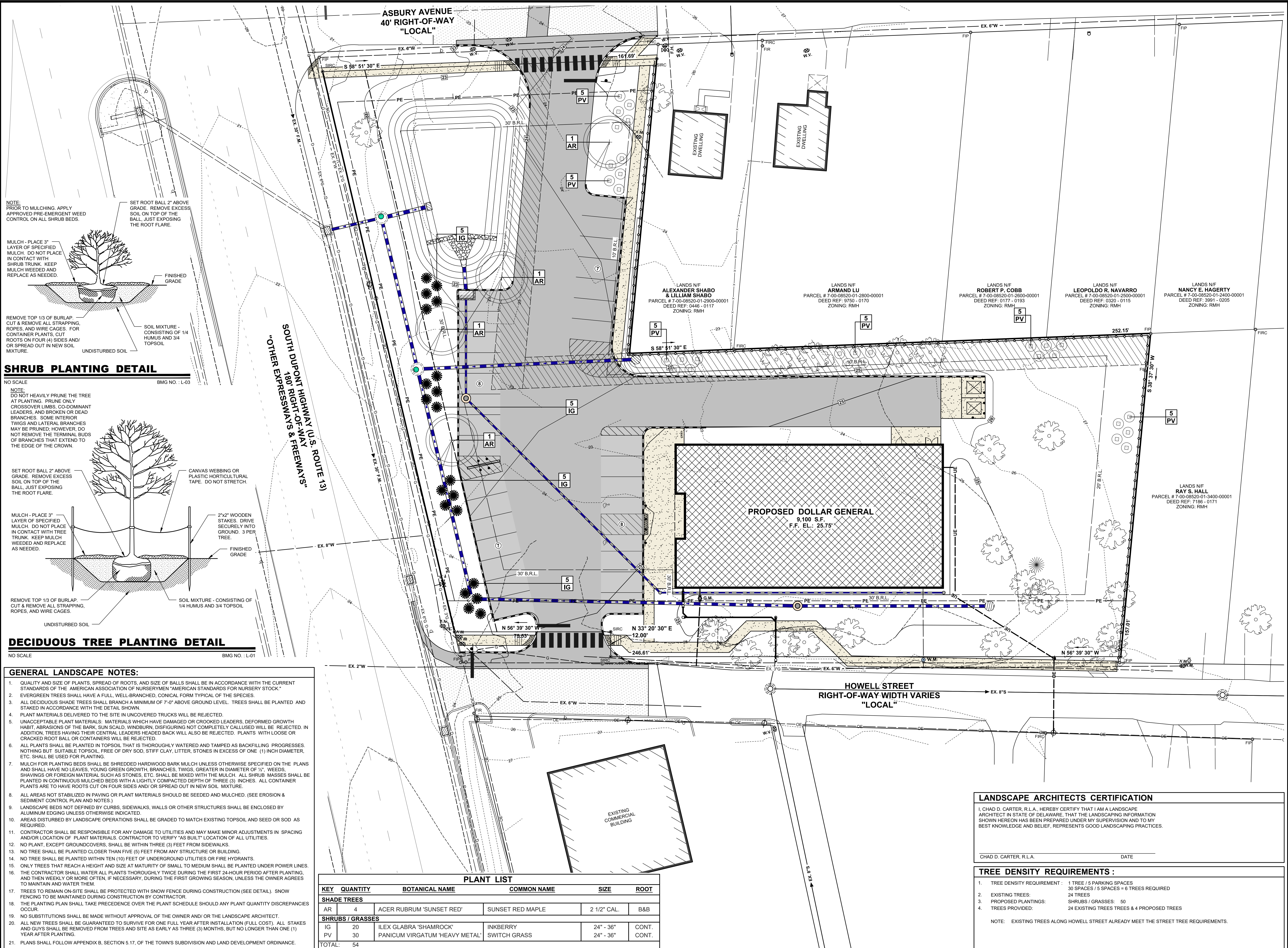

SHRUB PLANTING DETAIL

NO SCALE BMG NO.: L-03

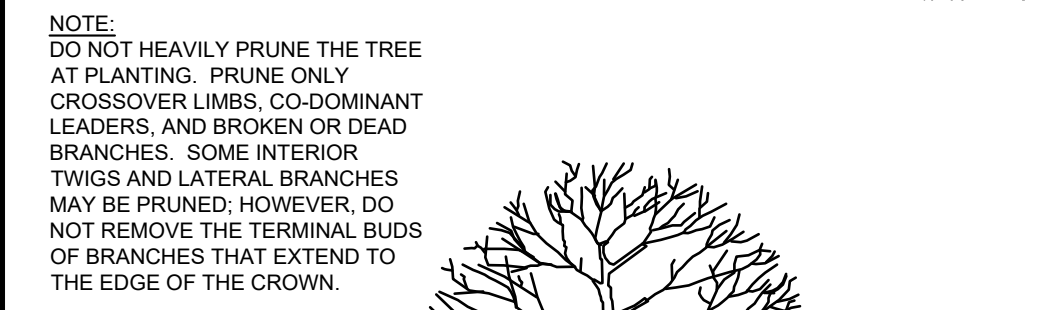

DECIDUOUS TREE PLANTING DETAIL

NO SCALE BMG NO.: L-01

GENERAL LANDSCAPE NOTES:

1. QUALITY AND SIZE OF PLANTS, SPREAD OF ROOTS, AND SIZE OF BALLS SHALL BE IN ACCORDANCE WITH THE CURRENT STANDARDS OF THE AMERICAN ASSOCIATION OF NURSERYMEN "AMERICAN STANDARDS FOR NURSERY STOCK."
2. EVERGREEN TREES SHALL HAVE A FULL, WELL-BRANCHED, CONICAL FORM TYPICAL OF THE SPECIES.
3. ALL DECIDUOUS SHADE TREES SHALL BRANCH A MINIMUM OF 7'-0" ABOVE GROUND LEVEL. TREES SHALL BE PLANTED AND STAKED IN ACCORDANCE WITH THE DETAIL SHOWN.
4. PLANT MATERIALS DELIVERED TO THE SITE IN UNCOVERED TRUCKS WILL BE REJECTED.
5. UNACCEPTABLE PLANT MATERIALS: MATERIALS WHICH HAVE DAMAGED OR CROOKED LEADERS, DEFORMED GROWTH HABIT, ABRASIONS OF THE BARK, SUN SCALD, WINDBURN, DISFIGURING NOT COMPLETELY CALLEDUS WILL BE REJECTED. IN ADDITION, TREES HAVING THEIR CENTRAL LEADERS HEADED BACK WILL ALSO BE REJECTED. PLANTS WITH LOOSE OR CRACKED ROOT BALL OR CONTAINERS WILL BE REJECTED.
6. ALL PLANTS SHALL BE PLANTED IN TOPSOIL THAT IS THOROUGHLY WATERED AND TAMPED AS BACKFILLING PROGRESSES. NOTHING BUT SUITABLE TOPSOIL, FREE OF DRY SOD, STIFF CLAY, LITTER, STONES IN EXCESS OF ONE (1) INCH DIAMETER, ETC. SHALL BE USED FOR PLANTING.
7. MULCH FOR PLANTING BEDS SHALL BE SHREDDED HARDWOOD BARK MULCH UNLESS OTHERWISE SPECIFIED ON THE PLANS AND SHALL HAVE NO LEAVES, YOUNG GREEN GROWTH, BRANCHES, TWIGS, GREATER IN DIAMETER OF 1/2", WEEDS, SHAVINGS OR FOREIGN MATERIAL SUCH AS STONES, ETC. SHALL BE MIXED WITH THE MULCH. ALL SHRUB MASSES SHALL BE PLANTED IN CONTINUOUS MULCH BEDS WITH A LIGHTLY COMPACTED DEPTH OF THREE (3) INCHES. ALL CONTAINER PLANTS ARE TO HAVE ROOTS CUT ON FOUR SIDES AND/OR SPREAD OUT IN NEW SOIL MIXTURE.
8. ALL AREAS NOT STABILIZED IN PAVING OR PLANT MATERIALS SHOULD BE SEEDED AND MULCHED. (SEE EROSION & SEDIMENT CONTROL PLAN AND NOTES.)
9. LANDSCAPE BEDS NOT DEFINED BY CURBS, SIDEWALKS, WALLS OR OTHER STRUCTURES SHALL BE ENCLOSED BY ALUMINUM EDGING UNLESS OTHERWISE INDICATED.
10. AREAS DISTURBED BY LANDSCAPE OPERATIONS SHALL BE GRADED TO MATCH EXISTING TOPSOIL AND SEED OR SOD AS REQUIRED.
11. CONTRACTOR SHALL BE RESPONSIBLE FOR ANY DAMAGE TO UTILITIES AND MAY MAKE MINOR ADJUSTMENTS IN SPACING AND/OR LOCATION OF PLANT MATERIALS. CONTRACTOR TO VERIFY "AS BUILT" LOCATION OF ALL UTILITIES.
12. NO PLANT, EXCEPT GROUNDCOVERS, SHALL BE WITHIN THREE (3) FEET FROM SIDEWALKS.
13. NO TREE SHALL BE PLANTED CLOSER THAN FIVE (5) FEET FROM ANY STRUCTURE OR BUILDING.
14. NO TREE SHALL BE PLANTED WITHIN TEN (10) FEET OF UNDERGROUND UTILITIES OR FIRE HYDRANTS.
15. ONLY TREES THAT REACH A HEIGHT AND SIZE AT MATURITY OF SMALL TO MEDIUM SHALL BE PLANTED UNDER POWER LINES. THE CONTRACTOR SHALL WATER ALL PLANTS THOROUGHLY TWICE DURING THE FIRST 24-HOUR PERIOD AFTER PLANTING, AND THEN WEEKLY OR MORE OFTEN, IF NECESSARY, DURING THE FIRST GROWING SEASON, UNLESS THE OWNER AGREES TO MAINTAIN AND WATER THEM.
16. TREES TO REMAIN ON-SITE SHALL BE PROTECTED WITH SNOW FENCE DURING CONSTRUCTION (SEE DETAIL). SNOW FENCING TO BE MAINTAINED DURING CONSTRUCTION BY CONTRACTOR.
17. THE PLANTING PLAN SHALL TAKE PRECEDENCE OVER THE PLANT SCHEDULE SHOULD ANY PLANT QUANTITY DISCREPANCIES OCCUR.
18. NO SUBSTITUTIONS SHALL BE MADE WITHOUT APPROVAL OF THE OWNER AND/OR THE LANDSCAPE ARCHITECT.
19. ALL NEW TREES SHALL BE GUARANTEED TO SURVIVE FOR ONE FULL YEAR AFTER INSTALLATION (FULL COST). ALL STAKES AND GUYS SHALL BE REMOVED FROM TREES AND SITE AS EARLY AS THREE (3) MONTHS, BUT NO LONGER THAN ONE (1) YEAR AFTER PLANTING.
20. PLANS SHALL FOLLOW APPENDIX B, SECTION 5.17, OF THE TOWN'S SUBDIVISION AND LAND DEVELOPMENT ORDINANCE.

PLANT LIST

KEY	QUANTITY	BOTANICAL NAME	COMMON NAME	SIZE	ROOT
SHADE TREES					
AR	4	ACER RUBRUM 'SUNSET RED'	SUNSET RED MAPLE	2 1/2" CAL.	B&B
SHRUBS / GRASSES					
IG	20	ILEX GLABRA 'SHAMROCK'	INKBERRY	24" - 36"	CONT.
PV	30	PANICUM VIRGATUM 'HEAVY METAL'	SWITCH GRASS	24" - 36"	CONT.
TOTAL:	54				

LANDSCAPE ARCHITECTS CERTIFICATION

I, CHAD D. CARTER, R.L.A., HEREBY CERTIFY THAT I AM A LANDSCAPE ARCHITECT IN STATE OF DELAWARE, THAT THE LANDSCAPING INFORMATION SHOWN HEREON HAS BEEN PREPARED UNDER MY SUPERVISION AND TO MY BEST KNOWLEDGE AND BELIEF, REPRESENTS GOOD LANDSCAPING PRACTICES.

CHAD D. CARTER, R.L.A. DATE

TREE DENSITY REQUIREMENTS:

1. TREE DENSITY REQUIREMENT: 1 TREE / 5 PARKING SPACES
2. EXISTING TREES: 30 SPACES / 5 SPACES = 6 TREES REQUIRED
3. PROPOSED PLANTINGS: 24 TREES
4. TREES PROVIDED: SHRUBS / GRASSES: 50
24 EXISTING TREES & 4 PROPOSED TREES

NOTE: EXISTING TREES ALONG HOWELL STREET ALREADY MEET THE STREET TREE REQUIREMENTS.



